

**PLEASE CHECK WWW.MOLEX.COM FOR LATEST PART INFORMATION**

**Part Number:** **0480372200**  
**Status:** **Active**  
**Description:** Universal Serial Bus (USB) Shielded I/O Plug, Type A, Right Angle, Surface Mount, Straight Tab 3.80mm (.150") , 0.76µm (30µ") Gold (Au) Plating, PCB Thickness 1.60mm (.063"), Tape on Reel Package, Lead Free

**Documents:**

[3D Model](#) [Product Specification PS-48037-001 \(PDF\)](#)  
[Drawing \(PDF\)](#) [RoHS Certificate of Compliance \(PDF\)](#)

**General**

Product Family	I/O Connectors
Series	48037
Application	Wire-to-Board
Comments	Straight Tab 3.80mm (.150")
Component Type	Plug
Product Name	USB
Type	A

**Physical**

Boot Color	N/A
Circuits (Loaded)	4
Circuits (maximum)	4
Gender	Plug
Keying to Mating Part	Yes
Lock to Mating Part	Yes
Material - Plating Mating	Gold
Material - Plating Termination	Tin
Number of Rows	1
Orientation	Right Angle
PCB Locator	Yes
PCB Retention	Yes
PCB Thickness Recommended (in)	0.063 In
PCB Thickness Recommended (mm)	1.60 mm
Packaging Type	Embossed Tape on Reel
Panel Mount	Yes
Pitch - Mating Interface (in)	0.078 In, 0.098 In
Pitch - Mating Interface (mm)	2.00 mm, 2.50 mm
Pitch - Term. Interface (in)	0.078 In, 0.098 In
Pitch - Term. Interface (mm)	2.00 mm, 2.50 mm
Plating min: Mating (µin)	30
Plating min: Mating (µm)	0.76
Polarized to Mating Part	Yes
Polarized to PCB	Yes
Ports	1
Surface Mount Compatible (SMC)	Yes
Temperature Range - Operating	-20°C to +85°C
Termination Interface: Style	Surface Mount
Waterproof / Dustproof	No

**Electrical**

Current - Maximum per Contact	1.5A
Shield Type	Full Shield
Shielded	Yes
Voltage - Maximum	150V AC (RMS)

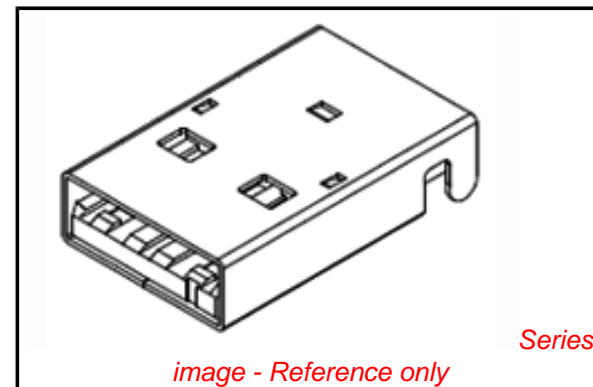

image - Reference only

**EU RoHS**

**ELV and RoHS  
Compliant**  
**REACH SVHC**  
 Not Reviewed  
**Halogen-Free  
Status**

**China RoHS**



**Need more information on product  
environmental compliance?**

Email [productcompliance@molex.com](mailto:productcompliance@molex.com)  
 For a multiple part number RoHS Certificate of Compliance, [click here](#)

Please visit the [Contact Us](#) section for any non-product compliance questions.

**Search Parts in this Series**

48037Series

**Mates With**

USB Type A Receptacle

**Solder Process Data**

Duration at Max. Process Temperature (seconds)	10
Lead-free Process Capability	Reflow Capable (SMT only)
Max. Cycles at Max. Process Temperature	1
Process Temperature max. C	260

**Material Info****Reference - Drawing Numbers**

Product Specification	PS-48037-001
Sales Drawing	SD-48037-004

This document was generated on 04/06/2010

**PLEASE CHECK [WWW.MOLEX.COM](http://WWW.MOLEX.COM) FOR LATEST PART INFORMATION**

10 9 8 7 6 5 4 3 2 1

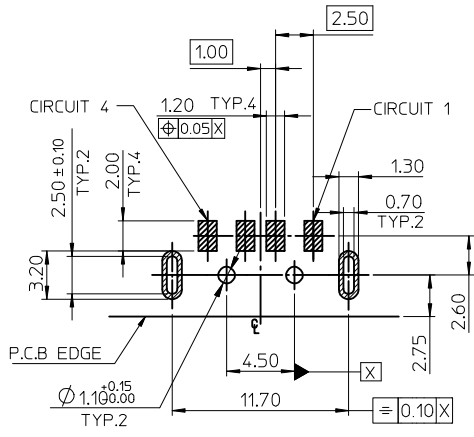
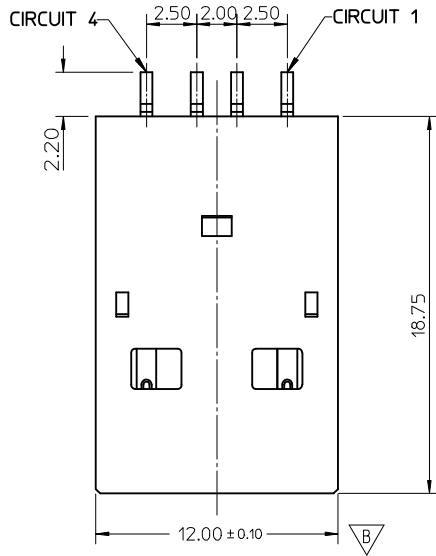

RECOMMEND P.C.B LAYOUT  
GENERAL TOLERANCE ± 0.05

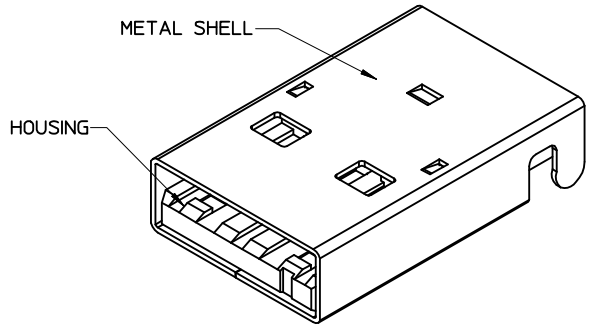

- NOTES:
- MATERIAL:  
HOUSING: NYLON 46, GLASS FIBER FILLED, UL94V-0, COLOR: BLACK.  
SHELL: COLD ROLLED STEEL.  
TERMINAL: BRASS.
  - FINISH:  
TERMINAL:  
SELECTIVE GOLD(Au) IN CONTACT AREA, THICKNESS=30 MICROINCH MINIMUM;  
SELECTIVE TIN(Sn) IN SOLDER TAIL AREA, THICKNESS=120 MICROINCH MINIMUM;  
NICKEL(Ni) OVERALL.  
METAL SHELL:  
NICKEL(Ni) OVERALL,  
UNDER PLATED: COPPER(Cu) OVERALL, THICKNESS=50 MICROINCH MINIMUM.
  - RECOMMENDED PCB THICKNESS: 1.6mmY±0.05.
  - PRODUCT SPECIFICATION REFERS TO PS-48037-001.
  - PACKAGE SPECIFICATION REFERS TO PK-48037-210.
  - TEST SUMMARY REFERS TO TS-48037-001.
  - COPLANARITY TO BE 0.10mm MAX.
  - LEAD FREE AND RoHS COMPLIANT PRODUCT.
  - DATE CODE:  
X X X X X  
YEAR WEEK DAY

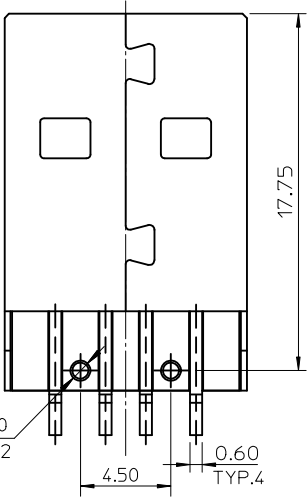
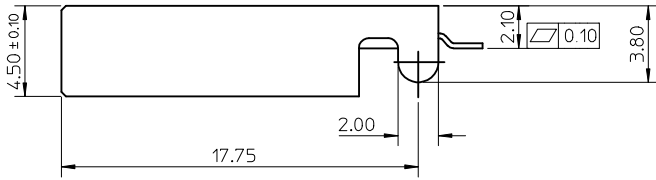
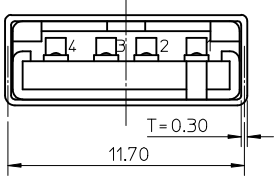

REVISED EC NO: SH2009-0435 DRWN: LWZHOU 2008/12/29 CHKD: QMZHANG02 2008/12/29 APPR: HMWANG 2009/01/09	QUALITY SYMBOLS	GENERAL TOLERANCES (UNLESS SPECIFIED)		DIMENSION STYLE	SCALE	DESIGN UNITS	THIRD ANGLE PROJECTION	
	▽=0 ∇=0	mm	INCH	MM ONLY	3:1	METRIC		
		4 PLACES ± --- ± ---	3 PLACES ± --- ± ---	2 PLACES ± 0.25 ± ---	1 PLACE ± 0.25 ± ---	DRAWN BY DATE TITLE TOM 2006/02/15 USB A TYPE PLUG SMT TYPE STR SHELL LEG(3.8MM) (LEAD-FREE VERSION)		
		ANGULAR ± 3 °		CHECKED BY DATE ROGER TSAI 2006/02/15			MOLEX MOLEX INCORPORATED	
	DRAFT WHERE APPLICABLE MUST REMAIN WITHIN DIMENSIONS		APPROVED BY DATE ALLEN LIN 2006/02/15		MATERIAL NO. 48037-2200		DOCUMENT NO. SD-48037-004	
		SIZE A3		THIS DRAWING CONTAINS INFORMATION THAT IS PROPRIETARY TO MOLEX INCORPORATED AND SHOULD NOT BE USED WITHOUT WRITTEN PERMISSION				

9 8 7 6 5 4 3 2 1