

**Type: PG57/FM , PG57/AM, PG57/SW , PG57/MW**

### Product Description

- 6.1 × 6.1mm Max.(L × W), 8.0mm Max. Height.
- Inductance:1~820μH.
- Operating frequency:20MHz Max.
- In addition to the reference versions of parameters shown here, custom designs are available to meet your exact requirements.



### Feature

- Variable shielded type.
- FM,AM,SW,MW types are available
- RoHS Compliance

### Dimensions (mm)

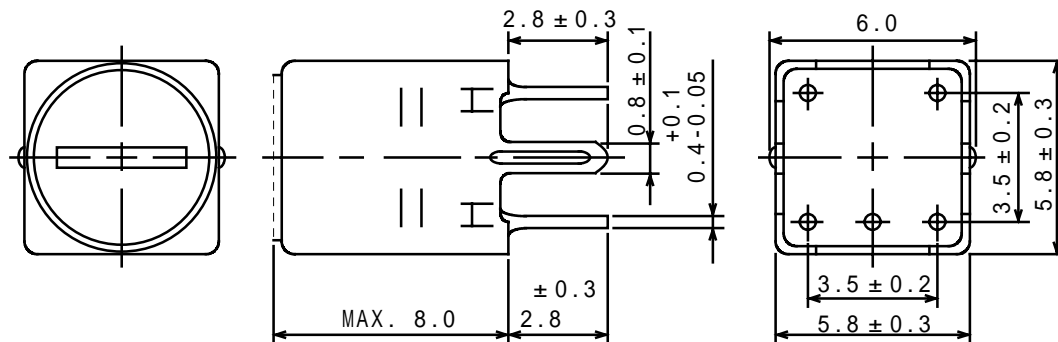

- \* Dimension does not include solder used on coil.
- \* Pin pitch should be measured at the root of terminal.
- \* Dimensions without tolerance are approx.

### Connection (Bottom View)

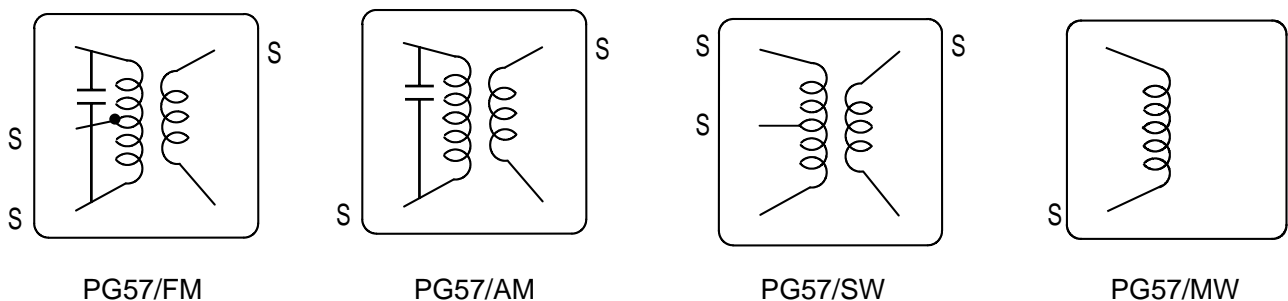

**Type: PG57/FM , PG57/AM, PG57/SW , PG57/MW**
**Specification (PG57/FM) (Part No. : 3151-T028)**

Item	(1 - 3)	Measuring Condition
Frequency	10.7MHz $\pm$ 2% Variable	
Unloaded Qu	45 Min	10.7 MHz
Capacity (Int.)	56pF $\pm$ 10%	
Ext stray capacity 3pF between (1-3) at measuring.		

**Specification (PG57/AM) (Part No. : 3150-T043)**

Item	(1 - 3)	Measuring Condition
Frequency	450kHz $\pm$ 2% Variable	
Unloaded Qu	30 Min.	450kHz
Capacity (Int.)	180pF $\pm$ 10%	

**Specification (PG57/SW) (Part No.: 3153-T013)**

Item	(1 - 3)	Measuring Condition
Using frequency	10MHz	
Inductance	10 $\mu$ H $\pm$ 4% Variable	7.96MHz
Unloaded Qu	50 Min	7.96 MHz

**Specification (PG57/MW) (Part No. : 3152-T023)**

Item	(1 - 3)	Measuring Condition
Inductance	660 $\mu$ H $\pm$ 5% Variable	796kHz
Unloaded Qu	65 Min	796kHz