

PRINCIPAL SPECIFICATIONS

Model Number	RF/LO Frequency, MHz	LO Drive, dBm, Nom.	IF, MHz	Operating Range, MHz	Conversion Loss, dB		Port Isolation, Min. dB			1 dB Compr. Point, dBm	Input Intercept Point, dBm	1 dB Desens. Level, dBm
					Max.	Typ.	L-R	L-X	R-X			
DMM-4-250	5 - 500	+13	DC-500	5 - 100	9.0	5.5	40	25	20	+8	+19	+6
				100 - 400	8.0	6.5	30	15	15			
				400 - 500	9.0	7.5	30	15	15			

All specifications are as measured in a 50Ω system, at nominal LO power, in a downconverter application

Package Outline

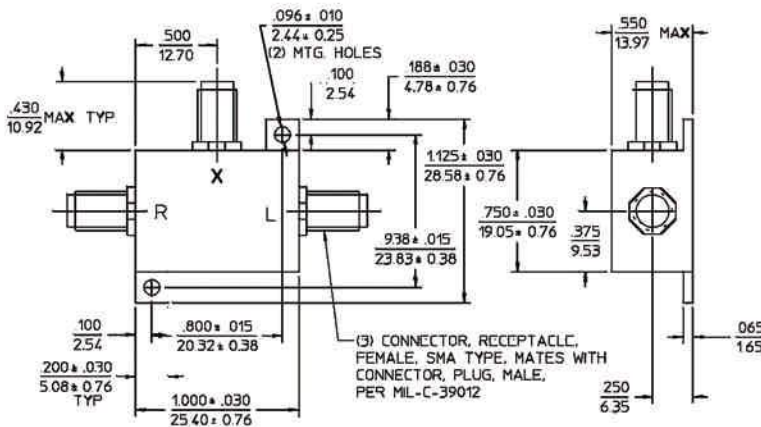

NOTES: 1. Tolerance on 3 place decimals ±.020(.51) except as noted.
2. Dimensions in inches over millimeters.

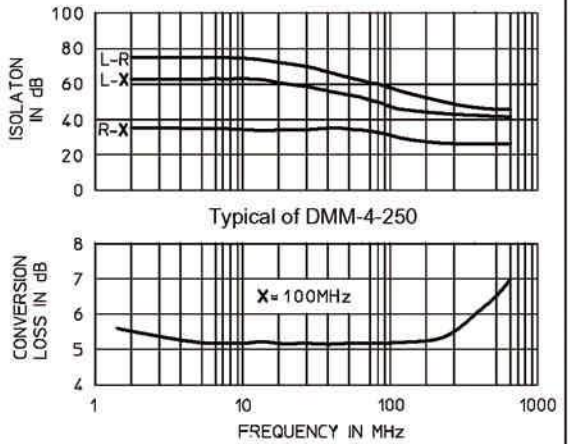

General Notes:

The DMM-4-250 Double Balanced Mixer covers the frequency range of 5 to 500 MHz. The DMM-4-250 uses four high barrier diodes in the ring modulator to yield a mixer with high third order intercept.

24May96

GENERAL SPECIFICATIONS

Impedance:	50 Ω nom.
Useful LO Drive:	±3 dB of nominal
SSB Noise Figure:	Within ±1 dB of Conversion Loss
DC Offset Voltage:	5 mV typ.
DC Polarity:	Positive
Weight, nominal:	0.65 oz (18 g)
Operating Temperature:	-55° to +85°C