

**PLEASE CHECK WWW.MOLEX.COM FOR LATEST PART INFORMATION**

**Part Number:** **0310681010**  
**Status:** **Active**  
**Overview:** H-DAC™ 64 Single Row  
**Description:** 2.54mm (.100") H-DAC 64™, 4 Way Receptacle Assembly, Single-Row, Polarization A

**Documents:**

[Drawing \(PDF\)](#) [Product Specification PS-31100-0001 \(PDF\)](#)  
[Application Specification \(PDF\)](#) [RoHS Certificate of Compliance \(PDF\)](#)  
[Product Specification PS-31067-0001 \(PDF\)](#)

**General**

Product Family Crimp Housings  
Series 31068  
Comments Polarization Option A, Black  
Overview H-DAC™ 64 Single Row  
Product Name H-DAC 64™

**Physical**

Circuits (maximum) 4  
Circuits Detail 4  
Color - Resin Black, White  
Gender Female  
Glow-Wire Compliant No  
Keying to Mating Part None  
Lock to Mating Part Yes  
Material - Resin Modified Polystyrene, Polyester  
Number of Rows 1  
Packaging Type Bag  
Panel Mount No  
Pitch - Mating Interface (in) 0.100 In  
Pitch - Mating Interface (mm) 2.54 mm  
Pitch - Term. Interface (in) 0.100 In  
Pitch - Term. Interface (mm) 2.54 mm  
Polarized to Mating Part Yes  
Ports 1  
Stackable No  
Temperature Range - Operating -40°C to +100°C

**Electrical**

Current - Maximum per Contact 11A, 9A

**Material Info**

**Reference - Drawing Numbers**

Product Specification PS-31067-0001, PS-31100-0001  
Sales Drawing SD-31109-003



**EU RoHS**

**ELV and RoHS Compliant**  
**REACH SVHC**  
**Contains SVHC: No**  
**Halogen-Free Status**

**China RoHS**



**Need more information on product environmental compliance?**

Email [productcompliance@molex.com](mailto:productcompliance@molex.com)  
For a multiple part number RoHS Certificate of Compliance, [click here](#)

Please visit the [Contact Us](#) section for any non-product compliance questions.

**Search Parts in this Series**

31068Series

**Mates With**

H-DAC 64™, 4 Way Male Housing Assembly 310681040 , 310681070 , 311000040 , 311010040

**Use With**

See Product Spec

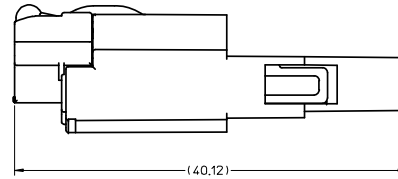
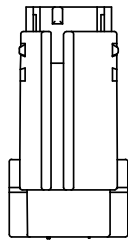

OVERALL MATED LENGTH

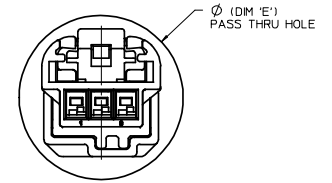

MALE AND FEMALE ASSEMBLY  
PASS THRU VIEW  
(CAD GENERATED)

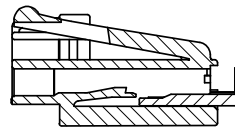
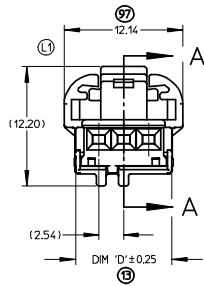
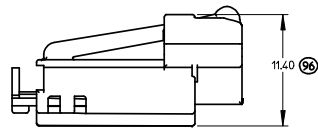

SECTION A-A  
SCALE 4:1

MATING SIDE

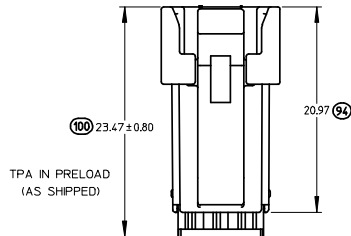

TPA IN PRELOAD  
(AS SHIPPED)

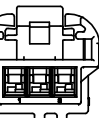

WIRE SIDE

- NOTES:
1. MATERIAL: HOUSING: SPS GLASS FILLED, COLOR SEE CHART.  
TPA: PBT
  2. PRODUCT SPECIFICATIONS - IN-LINE MATING INTERFACE: PS-31067-0001.  
- DIRECT CONNECT MATING INTERFACE: PS-31100-0001
  3. PACKAGING SPECIFICATION: DRAWING PK-30907-737.
  4. MATES WITH: SEE SALES DRAWINGS SD-31100-003 (MALE IN-LINE),  
SD-31197-003 (RIGHT ANGLE HEADER), SD-31101-114 (VERTICAL  
"WINGED" HEADER), AND SD-31206-003 (VERTICAL HEADER).
  5. TERMINAL PLATING: TIN (Sn) OVERALL, BRITTE FINISH.  
THICKNESS = 15 MICROMETER MINIMUM,  
NICKEL (Ni) UNDERPLATE OVERALL.
  6. PACKAGING: PLEASE REFERENCE MOLEX SPECIFICATION PS-34646-001,  
AVAILABLE AT WWW.MOLEX.COM. (REFERENCE: TPAs THAT ARE FOUND IN  
SEATED (FINAL LOCK) POSITION)
  7. APPLICATION SPECIFICATION: AS-31067-100.

<b>ENTER DESCRIPTION</b> IEC NO. UAU2008-0767 DRAWN: MACHUGA 2008/07/08 CHECKED: CHYKOBLOCK 2008/07/09 APPR: SMARCEAU 2008/07/09	<b>QUALITY SYMBOLS</b> ▽=0 ▽=0	<b>GENERAL TOLERANCES (UNLESS SPECIFIED)</b>		<b>DIMENSION STYLE</b> MM ONLY	<b>SCALE</b> 1:1	<b>DESIGN UNITS</b> METRIC	THIRD ANGLE PROJECTION		
		4 PLACES ± --- ± ---	3 PLACES ± --- ± ---	2 PLACES ± 0.13 ± ---	1 PLACE ± 0.25 ± ---	ANGLAR ± 1/2°	DRAWN BY DATE BDLCK01 6/22/2007	CHECKED BY DATE CDILLON 6/22/2007	APPROVED BY DATE
		DRAFT WHERE APPLICABLE MUST REMAIN WITHIN DIMENSIONS		MATERIAL NO. SEE CHART	DOCUMENT NO. SD-31109-003	MOLEX INCORPORATED	SHEET NO. 1 OF 4		
		THIS DRAWING CONTAINS INFORMATION THAT IS PROPRIETARY TO MOLEX INCORPORATED AND SHOULD NOT BE USED WITHOUT WRITTEN PERMISSION							

FEMALE VIEWED FROM MATING SIDE

3 WAY POLARIZATION 'A'

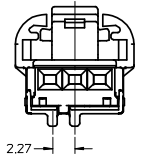

3 WAY POLARIZATION 'B'

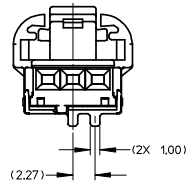

3 WAY POLARIZATION 'C'

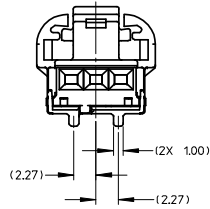

4 WAY POLARIZATION 'A'

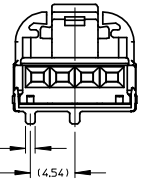

4 WAY POLARIZATION 'B'

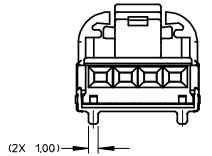

4 WAY POLARIZATION 'C'

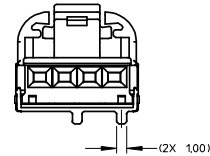

5 WAY POLARIZATION 'A'

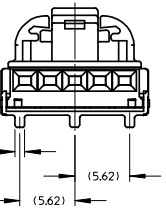

5 WAY POLARIZATION 'B'

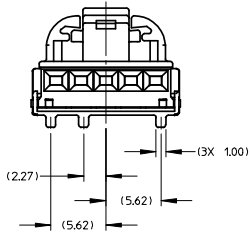

5 WAY POLARIZATION 'C'

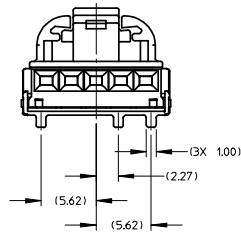

6 WAY POLARIZATION 'A'

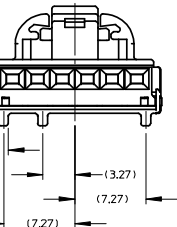

6 WAY POLARIZATION 'B'

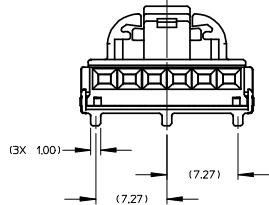

6 WAY POLARIZATION 'C'

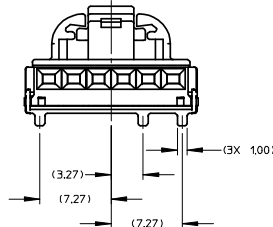

BILL OF MATERIALS						MATING ASSEMBLIES PART NUMBERS					
ASSEMBLY PART NUMBER	DESCRIPTION	PART NUMBER	DESCRIPTION	COLOR	DIM 'D'	DIM 'E'	INLINE MALE ASSEMBLY W/O XMAS SLOT	INLINE MALE ASSEMBLY W/ XMAS SLOT	RIGHT ANGLE MALE HEADER ASSEMBLY	VERTICAL MALE HEADER ASSEMBLY	VERTICAL MALE WINGED HEADER ASSY
31067-1010	3 WAY FEMALE ASSEMBLY POLARIZATION 'A'	31111-0030	FEMALE HOUSING	BLACK	9.80	16.76	31067-1040	31067-1070	31100-0030 NOT TOOLED	31101-0030 NOT TOOLED	TBD
		31113-0030	TPA	NATURAL (WHITE)							
31067-1011	3 WAY FEMALE ASSEMBLY POLARIZATION 'B'	31111-0031	FEMALE HOUSING	GRAY	9.80	16.76	31067-1041	31067-1071	31100-0031 NOT TOOLED	31101-0031 NOT TOOLED	TBD
		31113-0030	TPA	NATURAL (WHITE)							
31067-1012	3 WAY FEMALE ASSEMBLY POLARIZATION 'C'	31111-0032	FEMALE HOUSING	BROWN	9.80	16.76	31067-1042	31067-1072	31100-0032 NOT TOOLED	31101-0032 NOT TOOLED	TBD
		31113-0030	TPA	NATURAL (WHITE)							
31068-1010	4 WAY FEMALE ASSEMBLY POLARIZATION 'A'	31157-0040	FEMALE HOUSING	BLACK	12.34	18.25	31068-1040	31068-1070	31100-0040	31101-0040	31101-1140
		31158-0040	TPA	NATURAL (WHITE)							
31068-1011	4 WAY FEMALE ASSEMBLY POLARIZATION 'B'	31157-0041	FEMALE HOUSING	GRAY	12.34	18.25	31068-1041	31068-1071	31100-0041	31101-0041	31101-1240
		31158-0040	TPA	NATURAL (WHITE)							
31068-1012	4 WAY FEMALE ASSEMBLY POLARIZATION 'C'	31157-0042	FEMALE HOUSING	BROWN	12.34	18.25	31068-1042	31068-1072	31100-0042	31101-0042	31101-1340
		31158-0040	TPA	NATURAL (WHITE)							
31072-1010	5 WAY FEMALE ASSEMBLY POLARIZATION 'A'	31160-0050	FEMALE HOUSING	BLACK	14.88	20.25	31072-1040	31072-1070	31100-0050 NOT TOOLED	31101-0050 NOT TOOLED	TBD
		31161-0050	TPA	NATURAL (WHITE)							
31072-1011	5 WAY FEMALE ASSEMBLY POLARIZATION 'B'	31160-0051	FEMALE HOUSING	GRAY	14.88	20.25	31072-1041	31072-1071	31100-0051 NOT TOOLED	31101-0051 NOT TOOLED	TBD
		31161-0050	TPA	NATURAL (WHITE)							
31072-1012	5 WAY FEMALE ASSEMBLY POLARIZATION 'C'	31160-0052	FEMALE HOUSING	BROWN	14.88	20.25	31072-1042	31072-1072	31100-0052 NOT TOOLED	31101-0052 NOT TOOLED	TBD
		31161-0050	TPA	NATURAL (WHITE)							
31073-1010	6 WAY FEMALE ASSEMBLY POLARIZATION 'A'	31163-0060	FEMALE HOUSING	BLACK	17.42	22.75	31073-1040	31073-1070	31100-0060 NOT TOOLED	31101-0060 NOT TOOLED	TBD
		31164-0060	TPA	NATURAL (WHITE)							
31073-1011	6 WAY FEMALE ASSEMBLY POLARIZATION 'B'	31163-0061	FEMALE HOUSING	GRAY	17.42	22.75	31073-1041	31073-1071	31100-0061 NOT TOOLED	31101-0061 NOT TOOLED	TBD
		31164-0060	TPA	NATURAL (WHITE)							
31073-1012	6 WAY FEMALE ASSEMBLY POLARIZATION 'C'	31163-0062	FEMALE HOUSING	BROWN	17.42	22.75	31073-1042	31073-1072	31100-0062 NOT TOOLED	31101-0062 NOT TOOLED	TBD
		31164-0060	TPA	NATURAL (WHITE)							

ENTER DESCRIPTION IEC NO. UAU2008-0767 DRAWN/TMACHUGA 2008/07/08 CHYK/BDO/CK 2008/07/09 APPR./SMARCEAU 2008/07/09	QUALITY SYMBOLS ▽=0 ▽=0	GENERAL TOLERANCES (UNLESS SPECIFIED)		DIMENSION STYLE MM ONLY	SCALE 1:1	DESIGN UNITS METRIC	THIRD ANGLE PROJECTION		
		4 PLACES ± mm INCH 3 PLACES ± --- ± --- 2 PLACES ± 0.13 ± --- 1 PLACE ± 0.25 ± ---	DRAWN BY DATE BDI/CK01 6/22/2007		TITLE FEMALE ASSEMBLY CHARTED SALES DRAWING				
		DRAFT WHERE APPLICABLE MUST REMAIN WITHIN DIMENSIONS		MATERIAL NO. SEE CHART		DOCUMENT NO. SD-31109-003		SHEET NO. 2 OF 4	
		THIS DRAWING CONTAINS INFORMATION THAT IS PROPRIETARY TO MOLEX INCORPORATED AND SHOULD NOT BE USED WITHOUT WRITTEN PERMISSION							



# REFERENCE ONLY

3 WAY  
POLARIZATION "A"

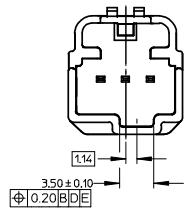

3 WAY  
POLARIZATION "B"

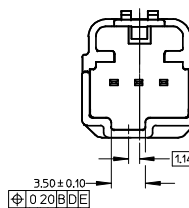

3 WAY  
POLARIZATION "C"

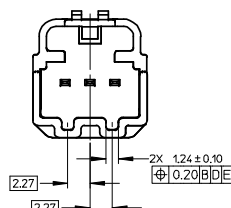

4 WAY  
POLARIZATION "A"

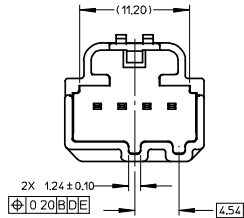

4 WAY  
POLARIZATION "B"

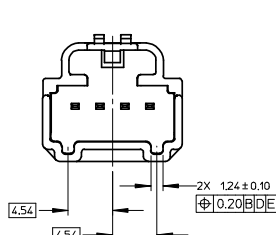

4 WAY  
POLARIZATION "C"

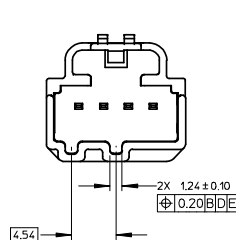

5 WAY  
POLARIZATION "A"

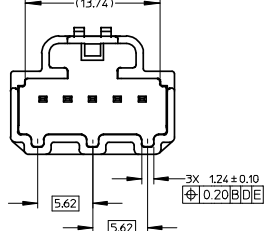

5 WAY  
POLARIZATION "B"

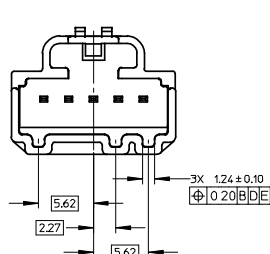

5 WAY  
POLARIZATION "C"

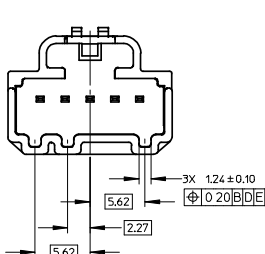

6 WAY  
POLARIZATION "A"

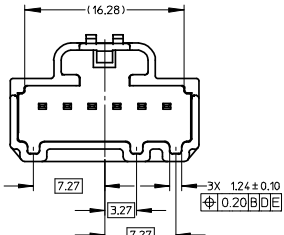

6 WAY  
POLARIZATION "B"

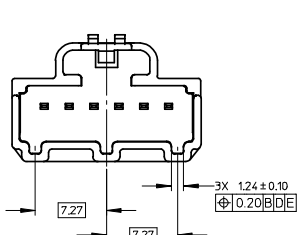

6 WAY  
POLARIZATION "C"

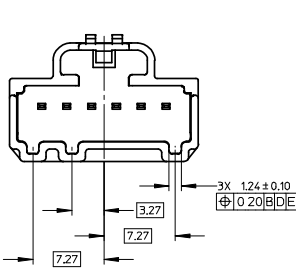

<b>ENTER DESCRIPTION</b> IEC NO: UAU2008-0767 DRAWN: MACHIGA 2008/07/08 CHKD: BDI CK 2008/07/09 APPR: SMARCEAU 2008/07/09 REV: DESCRIPTION	<b>QUALITY SYMBOLS</b> ▽=0 ▽=0		<b>GENERAL TOLERANCES (UNLESS SPECIFIED)</b> mm INCH		<b>DIMENSION STYLE</b> MM ONLY		SCALE 4:1 DESIGN UNITS METRIC		THIRD ANGLE PROJECTION	
	4 PLACES ± --- ± --- 3 PLACES ± --- ± --- 2 PLACES ± 0.13 ± --- 1 PLACE ± 0.25 ± ---		ANGULAR ± 1/2°		DRAFT WHERE APPLICABLE MUST REMAIN WITHIN DIMENSIONS		MATERIAL NO. SEE CHART		DOCUMENT NO. SD-31109-003	
	DRAWN BY BDI CK 01 DATE 6/22/2007 CHECKED BY CDILLON DATE 6/22/2007 APPROVED BY DATE		MOLEX INCORPORATED		SHEET NO. 4 OF 4					
	THIS DRAWING CONTAINS INFORMATION THAT IS PROPRIETARY TO MOLEX INCORPORATED AND SHOULD NOT BE USED WITHOUT WRITTEN PERMISSION									