

# ACP-1320/1320MB

**1U Rackmount Chassis for Full-Size SBC/Motherboard with Dual SAS/SATA HDD Trays**

**NEW**



## Features

- Space-saving 1U rackmount chassis, ideal building block for business expansion
- Supports ATX/MicroATX motherboard and PICMG full-size SBC
- LED indicators for LAN connectivity, alarm notification of power supply, HDD activity, system fan, and in-chassis temperature
- Supports dual front-accessible SAS/SATA HDDs
- Supports one add-on card with optional riser card
- Supports both 250 W/300 W ATX/PFC power supply
- Efficient cooling design prevents the system from over-heating



## Specifications

Drive Bay	Slim Optical Disk Drive	Front-accessible	
	3.5"	1	2 SAS/SATA HDDs + 1
Cooling	Fan	4 (4 cm / 24 CFM x 3 + 15 CFM x 1) / 2 (4 cm / 24 CFM each)	
Front I/O Interface	USB	2	
Miscellaneous	LED Indicators	System: Power, HDD, temperature, fan, LAN1 and LAN2	
	Control	Dual SAS/SATA HDD trays: HDD power & HDD activity	
	Rear panel	Power switch, system reset and alarm reset button	
Environment		Operating	Non-Operating
	Temperature	0 ~ 40° C (32 ~ 104° F)	-20 ~ 60° C (-4 ~ 140° F)
	Humidity	10 ~ 85 % @ 40° C, non-condensing	10 ~ 95 % @ 40° C, non-condensing
	Vibration (5 ~ 500 Hz)	0.5 Grms	2 G
	Shock	10 G (with 11 ms duration, half sine wave)	30 G
Physical Characteristics	Dimensions (W x H x D)	480 x 44 x 620 mm (19" x 1.7" x 24.3")	
	Weight	8.8 kg (19.4 lb)	

\* This chassis supports processors up to Intel Pentium 4 84W, Core 2 Duo, and Core 2 Quad 95W. For server grade CPU cards like the PCE-7214 configured with SAS RAID card and SAS HDD, we suggest utilizing the Xeon CPU at 35 watts or under for better thermal dissipation. This is due to the thermal and the power consumption of the SAS HDD being much higher than the SATA HDD while the system is operating.

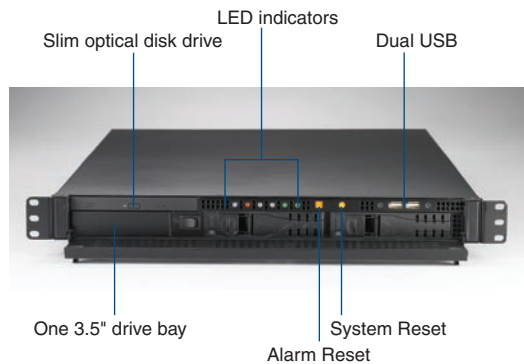

Dual front-accessible SAS/SATA HDD trays



Power | Temp. | LAN1  
HDD | Fan | LAN2

## Dimensions

Unit: mm [inch]

ACP-1320

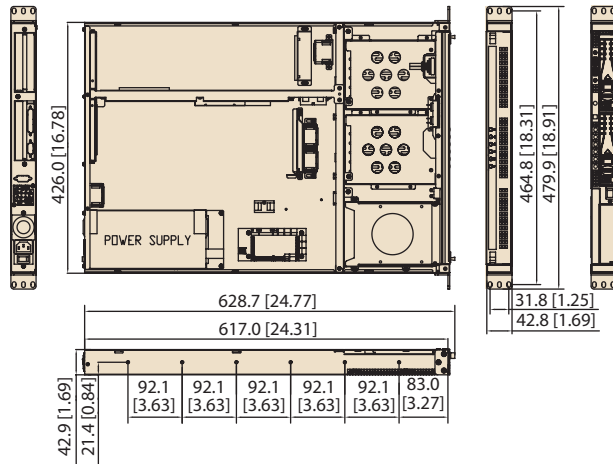

ACP-1320MB

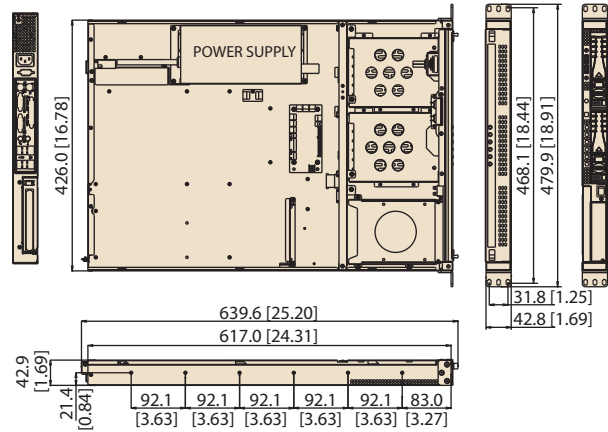

## Power Supply

Part Name	Watts	Input	Output	Specifications		
				Mini-load	Safety	MTBF
BP: 1757001797 MB: 1757001457 (ATX, PFC)	250 W	AC 100 ~ 240 V (full-range)	+5 V @ 23 A, +3.3 V @ 14 A +12 V @ 16 A, -12 V @ 0.5 A -5 V @ 0.2 A, +5 Vsb @ 2 A	+5 V @ 3 A, +12 V @ 2 A -5 V @ 0 A, -12 V @ 0.1 A +3.3 V @ 1 A, +5 Vsb @ 0.1 A	CE/UL/TUV/CB/CCC	114,000 hours @ 25° C
BP: 1757000160G MB: 1757000263 (ATX, PFC)	300 W	AC 100 ~ 240 V (full-range)	+5 V @ 25 A, +3.3 V @ 14 A +12 V @ 16 A, -12 V @ 1 A -5 V @ 0.5 A, +5 Vsb @ 2 A	+5 V @ 3 A, +12 V @ 2 A -5 V @ 0.05 A, -12 V @ 0.05 A +3.3 V @ 1 A, +5 Vsb @ 0.1 A	CE/UL/TUV/CB/CCC	100,000 hours @ 25° C

## Accessories

Part Name	Description
9686000089	40-pin IDE transfer daughter board for slim ODD
1960013266T000	1U LGA775 CPU cooler (supports up to 84 W)
1750000348	1U mobile CPU cooler supports up to 35 W
1750000432	1U socket 478 CPU cooler (supports up to 70 W)
96SDVR-8X-ST-SN-B	Black slim SATA 8X DVD-RW ROM
96CB-SATAPOWER-6P	SATA power wire 6-pin to big 4-pin
96FDD-144-TE-B1	Black 3.5" FDD (EoL in Dec. 2009)
9662132000E	Black 3.5" mobile HDD tray

## Ordering Information

Model Name	Power Supply	Motherboard / Backplane	Regulation
ACP-1320BP-00XE	-	-	-
ACP-1320BP-30ZE	1757000160G	-	CE
ACP-1320MB0-00XE	-	-	-
ACP-1320MB0-30ZE	1757000263	-	CE

\*ACP-1320MB does not support AIMB-763, 542, 562, 564 & 566 (with DVI port) because the height of the audio/DVI connector is over 1U.

## Riser Card Options

Part Name	Interface	Expansion Slot	Motherboard
AIMB-R4104-01A1E	PCIe x4	One PCIe x4	AIMB-762/764/554/ 556
AIMB-RP10P-01A1E	PCI	One PCI	AIMB-742/744/750/ 766/552/560