



**Features**

- Protection from lightning surge.
- Surface mounted Gas Arrester.
- IEC-61000-4-5.
- Impulse current capacity 2000A 8/20μs.
- Micro-Gap design.
- Electrostatic capacitance less than 0.6pF.

**Applications**

- CATV modem, Telecom protection, xBase T protection, Hub protection, Security systems, Data acquisition and Audio systems.

**Impulse Absorption Characteristics**

Impulse wave form 10/700μs-4kV, IEC61000-4-5

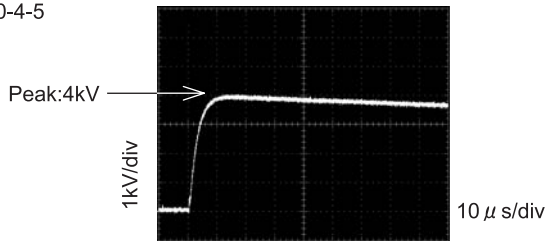

RHCA-201Q43U

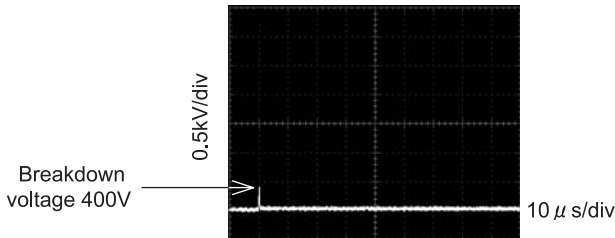

Safety Agency : Standard		Report NO.
UL	UL497B	E139599

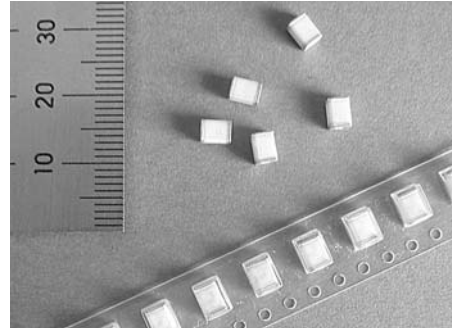

*Dimensions*

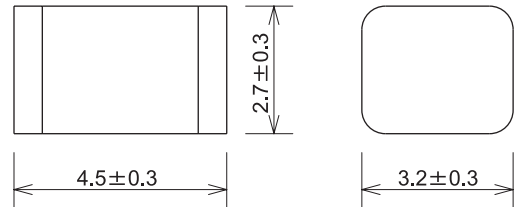

Unit: mm

Combination wave 1.2/50μs-8/20μs, 4.0kV IEC61000-4-5

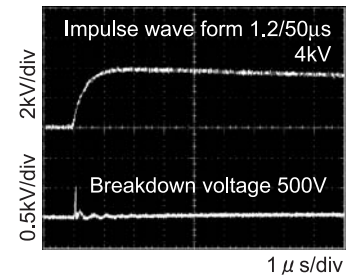

Example:

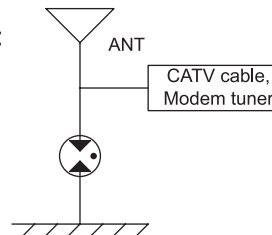

**Electrical Specifications**

Safety Agency	Model Number	DC Breakdown voltage	Insulation Resistance (DC 100V)	Capacitance (1MHz)	Impulse Life Test	Impulse Discharge Current	Impulse Withstanding Voltage Capacitance
	RHCA-900Q43U	200V (140 ~ 260)	1000MΩ Min. (DC50V)	0.6pF Max.	8/20 μ s, 100A 300 Times	8/20 μ s, 2000A Positive/Negative 5 times	10/700 μ s, 4kV (R=25Ω) Positive/Negative 5 times (conforms to ITU-T)
	RHCA-201Q43U	300V (210 ~ 390)					
	RHCA-301Q43U	350V (245 ~ 455)					
	RHCA-351Q43U	400V (280 ~ 520)					
	RHCA-401R43U	400V (332 ~ 520)					
	RHCA-401Q43U*	350V (245 ~ 455)					
	RHCA-501Q43U	400V (280 ~ 520)					
	RHCA-601R43U	400V (332 ~ 520)					

\* Conforms to ITU-T K.21 Enhanced test



### Part Numbering Systems

RHCA	201	Q			43	U	
Series	DC Breakdown Voltage 201: 201X10 =200V	Tolerance			Size	Packing form	
		P	Q	R	43	U	B
		±20%	±30%	+30% -17%	4.5(L)×3.2(W)	Taping	Bulk

### Recommended Land Pattern

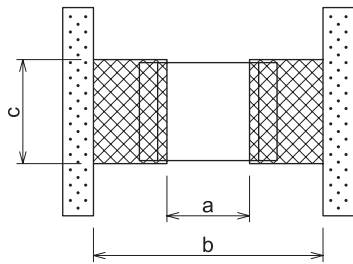

Land  
 Solder resist

	Dimensions (mm)		
	a	b	c
Reflow Soldering	2.7	6.5 to 8.5	3.4
Flow Soldering	2.9	6.5 to 9.5	3.6

### Taping Dimensions

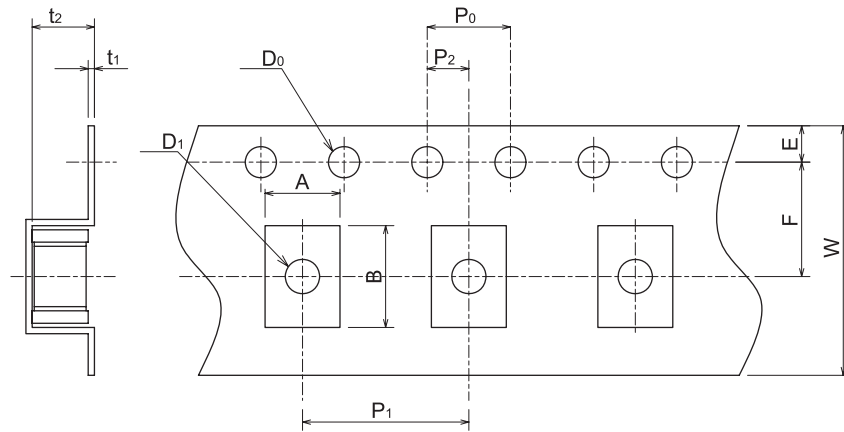

Unit: mm

A	B	W	F	E	P <sub>1</sub>	P <sub>2</sub>	P <sub>0</sub>
3.6±0.2	4.9±0.2	12.0±0.3	5.5±0.05	1.75±0.1	8.0±0.1	2.0±0.05	4.0±0.1

D <sub>0</sub>	D <sub>1</sub>	t <sub>1</sub>	t <sub>2</sub>
φ 1.5 <sup>+0.1</sup> <sub>-0</sub>	φ 1.65±0.15	0.30±0.1	3.0±0.2

### Reel Dimensions (3000pcs per one reel)

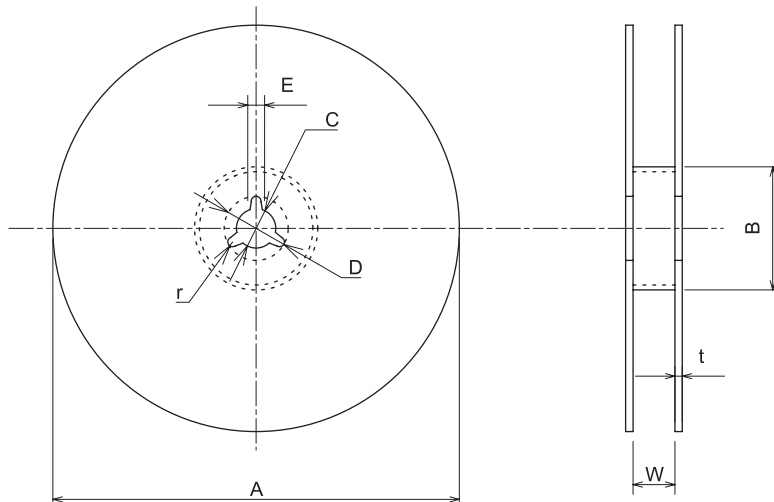

Unit: mm

A	B	C	D	E	W	t	r
φ 330±2	φ 80±0.5	φ 13.0±0.5	φ 21±0.8	2.0±0.5	13.5 <sup>+1.0</sup> <sub>-0.5</sub>	1.6±0.5	1.0