

P-tec Corp. Tel:(800)688-0613
 2405 Commerce Circle Tel:(719) 589 3122
 Alamosa Co. 81101 Fax:(719) 589 3592
 www.p-tec.net sales@p-tec.net



PL00291 Series SMD LED Right Angle 1104 Package

Features

- *Oval Lens Side View Package 3.0 x 2.0 x 1.0mm
- *AlGaInP Ultra Bright Red Chip used
- *Low Current Requirements
- *High Light Output
- *Compatible with IR Solder-Process
- *Industry Standard Footprint
- *2000 or 1000 pcs per Reel
- *RoHS Compliant

Absolute Maximum Ratings at $T_A = 25^\circ\text{C}$

| | |
|--|----------------------|
| Power Dissipation | 130mW |
| Reverse Voltage (<100 μ A) | 5.0V |
| Max Forward Current | 50mA |
| Peak Forward Current(1/10 Duty Cycle, 0.1ms Pulse Width) | 150mA |
| Operating Temperature Range | -40°C to +85°C |
| Storage Temperature Range | -40°C to +85°C |
| Reflow Soldering Temperature..... | 260°C for 10 seconds |

Electrical & Optical Characteristics at $T_A = 25^\circ\text{C}$

| Part Number | Emitting Color | Chip Material | Peak Wave Length | Dominant Wave Length | Viewing Angle 2 θ 1/2 | Forward Voltage @20mA (V) | | Luminous Intensity @20mA (mcd) | |
|------------------|----------------|---------------|------------------|----------------------|------------------------------|---------------------------|-----|--------------------------------|-------|
| | | | | | | Typ | Max | Min | Typ |
| Water Clear Lens | | | nm | nm | Deg | | | | |
| PL00291-WCR25 | Red | AlGaInP | 650 | 630 | 120° | 2.1 | 2.6 | 90.0 | 150.0 |

Package Dimensions are in **Millimeters**. Tolerance is $\pm 0.25\text{mm}$ unless otherwise specified.

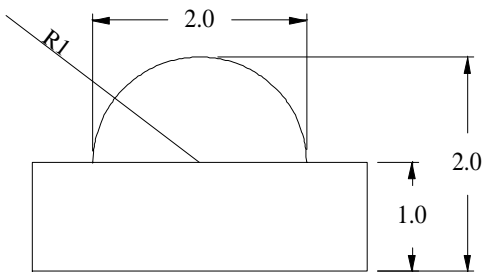
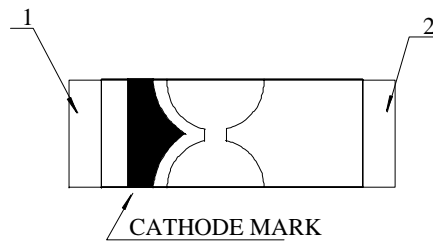
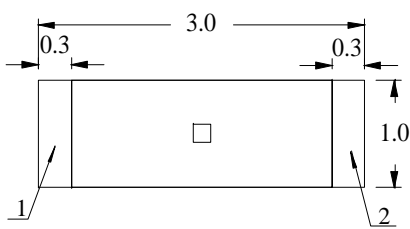

Recommended Soldering Pad Layout

