

PRINCIPAL SPECIFICATIONS

Model Number	Center Frequency, f_0	Usable Bandwidth, MHz
QHP-2N-***B	1 - 1000 MHz	$f_0 \pm 5\%$

For complete Model Number replace *** with desired Center Frequency, f_0 in MHz.

GENERAL SPECIFICATIONS

Bandwidth:	10%
Coupling:	- 3 dB nom.
Isolation:	23 dB min.
Insertion Loss:	0.3 dB max.
Phase Tolerance:	$90^\circ \pm 2^\circ$
Amplitude Balance:	0.75 dB max.
Impedance:	50Ω nom.
VSWR:	1.3:1 max.
CW Input:	1 Watt max.
Weight, nominal:	0.1 oz. (2.8 g)
Operating Temperature:	- 55° to +85°C

Meri-Pac™ N-Package Outline

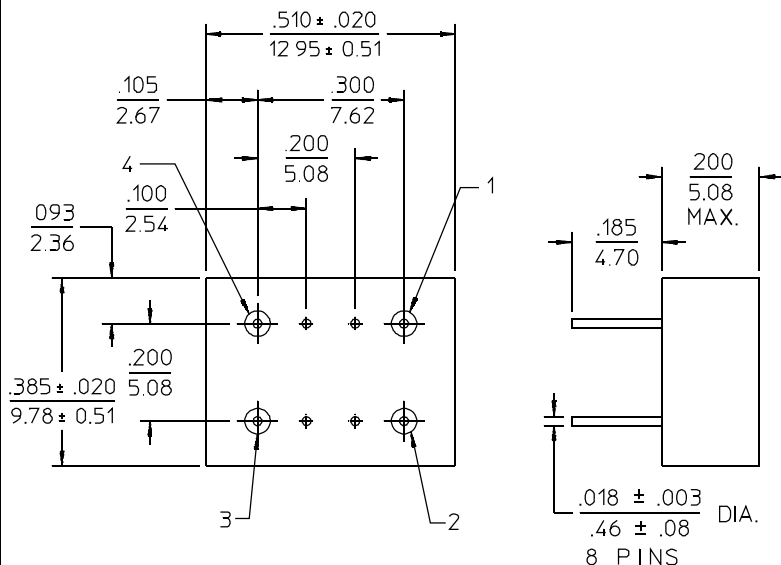

- NOTES: 1. Tolerance on 3 place decimals $\pm 0.10(.25)$ except as noted.
 2. Dimensions in inches over millimeters
 3. All unmarked pins are case ground.
 4. Pin dimensions apply only at body.

29Apr96

Phasing Diagram - A

	1	2	3	4
1		0°	- 90°	Isol
2	0°		Isol	- 90°
3	- 90°	Isol		0°
4	Isol	- 90°	0°	

General Notes:

- The QHP-2N series of Quadrature Hybrids covers 1 to 1000 MHz using a special lumped element design to reduce package size making it ideal for applications where an ultra-miniature package is essential.
- The 0.375" by 0.5" Meri-Pac™ housing is ideally suited to aerospace applications where inherent package reliability and hermeticity are essential.