

M12 Sized & Sealed Circular Connector

CM02B Series



Conforming Standard
NECA 4202

Waterproof
IP 67

Size
M12

Lock Type
Threaded Coupling

◆ OUTLINE

The CM02B series is a M12 sized and sealed circular connector developed for the connection of various sensors equipment.

This series conforms to NECA 4202, official standard of the Japan Electric Control Equipment Industry Association.

The use of the CM02B series will drastically decrease wiring work man-hours needed to connect sensors.

The CM02B series can be used in harsh environmental condition, having IP67 rated for protection against moisture and dust.

This series is also intemateable with our CM01 series.



◆ APPLICATIONS

1. Various sensors
2. Measurement equipment, medical equipment, telecommunications equipment, and various other electronic and electric equipment

◆ FEATURES

- UL94V-0 insulator flammability rating
- Over molding style cable assembly
- Number of Contacts : 4

◆ SPECIFICATIONS

Rated Current	3A/Contact	
Rated Voltage	125V DC	
Dielectric Withstanding Voltage	1,500V AC for 1 minute	
Insulation Resistance	1,000 MΩ Min. / Connector	100 MΩ Min. / Cable assembly
Operating Temperature Range	-25°C to +70°C	
Waterproof	IP67 when mated	
Cable	Conductor Size : 20AWG / Colored, 1-Brown 2-White 3-Blue 4-Black	

◆ MATERIALS/FINISH



Insulator	Plastic(UL94V-0)
Contact	Copper Alloy / Gold Plating
Coupling Ring	Zinc Alloy / Nickel Plating
Shell	Zinc Alloy or Copper Alloy / Nickel Plating
Nut & Washer	Zinc Alloy or Copper Alloy / Nickel Plating
Gasket	Synthetic Rubber / Black
Over Molding Resin	Plastic(UL94V-0)/Gray

▶ Double-Ended Cable Assemblies

- A plug connector with socket contacts and a jack connector with pin contacts

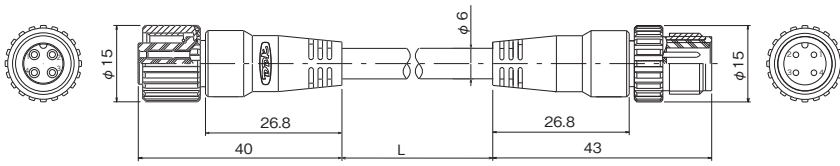

L	P/N
1,000	CM02BA-8DP4S-010
2,000	CM02BA-8DP4S-020
3,000	CM02BA-8DP4S-030
5,000	CM02BA-8DP4S-050
10,000	CM02BA-8DP4S-100

▶ Single-Ended Cable Assemblies

- Jack connector with pin contacts

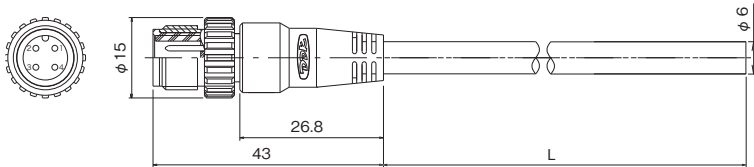

L	P/N
1,000	CM02B-8DJ4P-010
2,000	CM02B-8DJ4P-020
3,000	CM02B-8DJ4P-030
5,000	CM02B-8DJ4P-050
10,000	CM02B-8DJ4P-100

- Plug connector with socket contacts

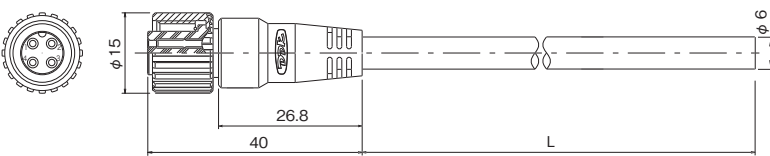

L	P/N
1,000	CM02B-8DP4S-010
2,000	CM02B-8DP4S-020
3,000	CM02B-8DP4S-030
5,000	CM02B-8DP4S-050
10,000	CM02B-8DP4S-100

▶ Double-Ended Cable Assemblies

- Jack connectors with pin contacts on both ends

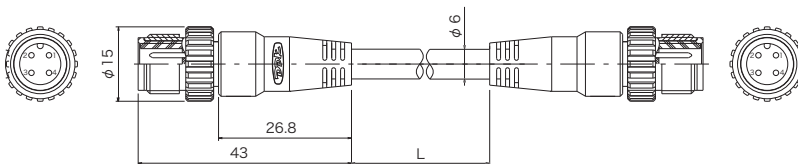

L	P/N
1,000	CM02BC-8DJ4P-010
2,000	CM02BC-8DJ4P-020
3,000	CM02BC-8DJ4P-030
5,000	CM02BC-8DJ4P-050
10,000	CM02BC-8DJ4P-100

- Plug connectors with socket contacts on both ends

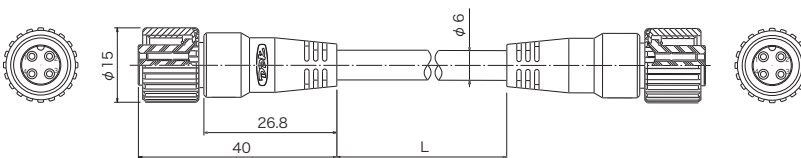

L	P/N
1,000	CM02BB-8DP4S-010
2,000	CM02BB-8DP4S-020
3,000	CM02BB-8DP4S-030
5,000	CM02BB-8DP4S-050
10,000	CM02BB-8DP4S-100

▶ Y-Joint Adapter

- Double-ended cable assemblies

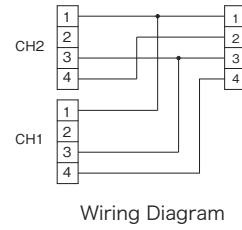
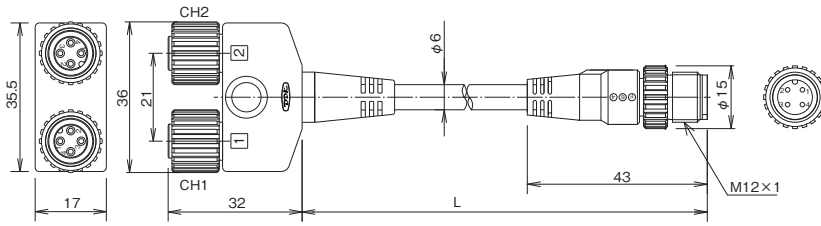

L	P/N
500	CM02B-8DYC4-005
1,000	CM02B-8DYC4-010
2,000	CM02B-8DYC4-020
3,000	CM02B-8DYC4-030
5,000	CM02B-8DYC4-050

- Connectors on both ends without cable

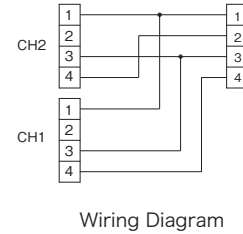
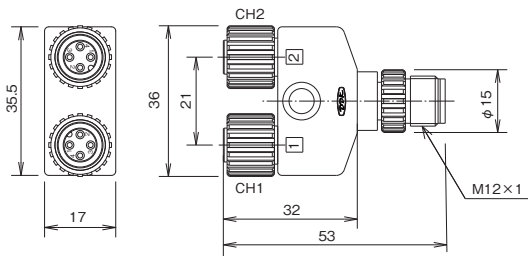

P/N
CM02B-8DYA4-CF

▶ Receptacle with Plastic Shell and Pin Contacts

Solder Dip

- Rear-mount configuration

P/N
CM01-8DRA-4P-CF(01)

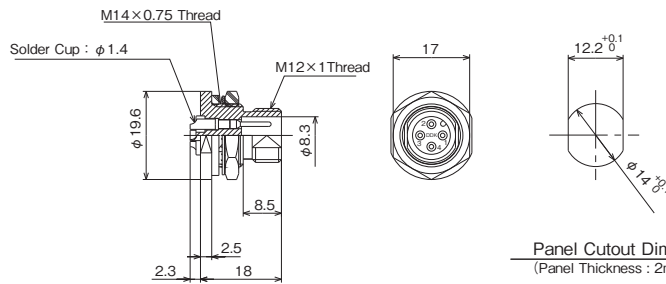

Soldering

- P C B Contacts
- Rear-mount configuration

P/N
CM02-8DR4PD(D1)-FG

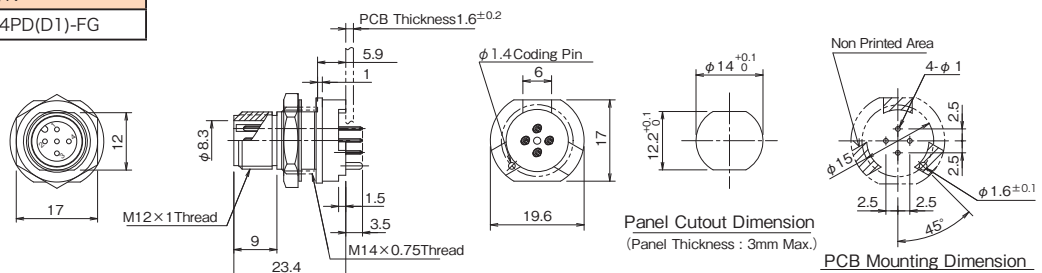

▶ Plug Receptacle with Metal Shell and Socket Contacts

Soldering

© CM01 Series

P/N
CM01-8DPRA-4S-CF(01)

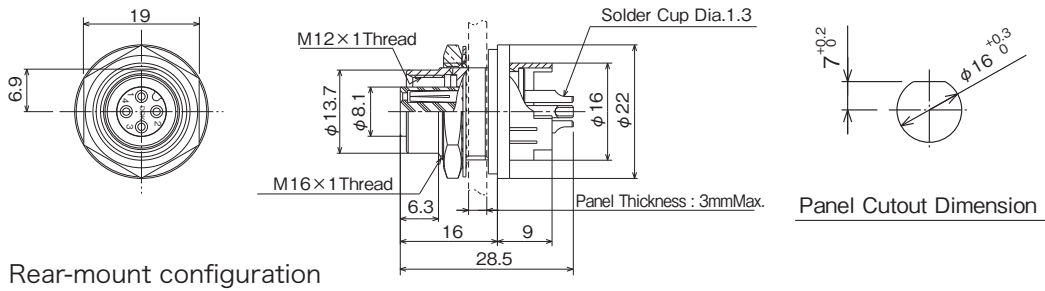

• Rear-mount configuration

Solder Dip

© CM01 Series

P/N
CM01-8DPRA-4SD-CF(01)

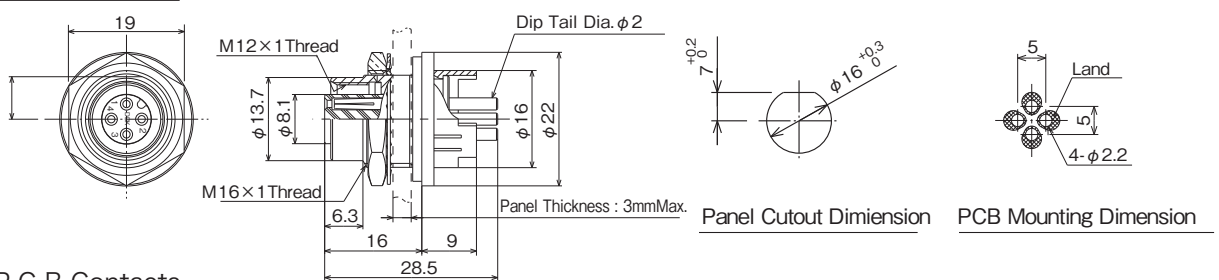
 • P C B Contacts
 • Rear-mount configuration

Soldering

P/N
CM02-8DPR4S-CF

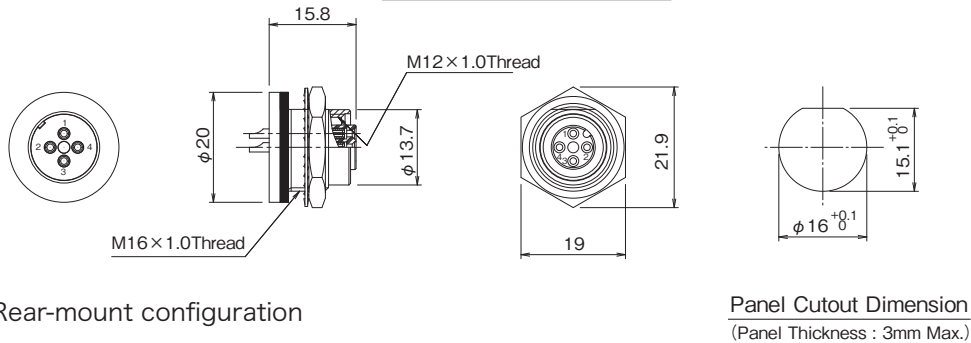

• Rear-mount configuration

▶ Plug Insert Assembly with Socket Contacts for PCB Mount

 • P C B Contacts
 • No shell

P/N
CM02-8DP4SD(D1)-FG

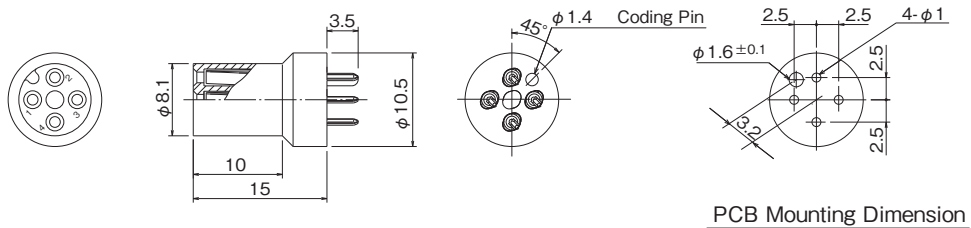

▶ Dust Cap for Plug & Plug Receptacle

P/N
CM01-P-CAP-CF

Metal Cap
Copper Alloy/Nickel Plating

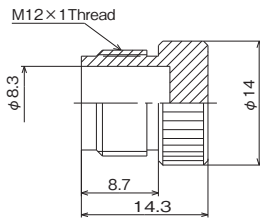

P/N
CM04-PR-DC

Plastic Cap
Plastic/Clear

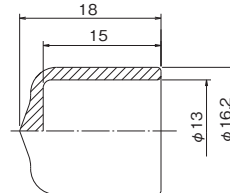

▶ Dust Cap for Jack & Receptacle

P/N
CM01-R-CAP-CF

Metal Cap
Copper Alloy/Nickel Plating

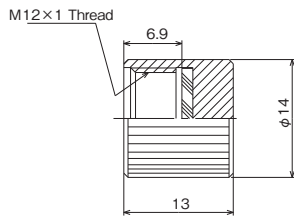

P/N
CM01-R-CAP(D1)

Metal Cap
Aluminum Alloy

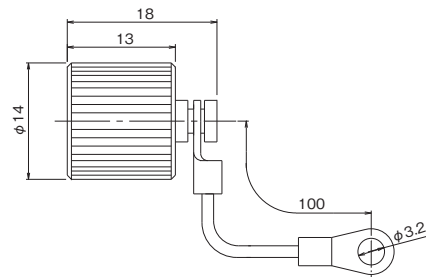

P/N
CM01-CAP

Plastic Cap
Plastic/Black

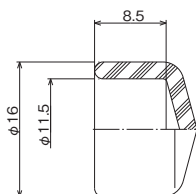

P/N
CM02B-J-DC

Plastic Cap
Plastic/Clear

