

| REV. | E.C.N. NUMBER AND REVISION COMMENTS | DATE    |
|------|-------------------------------------|---------|
| A    | E.C.N. #11440.                      | 9.07.07 |

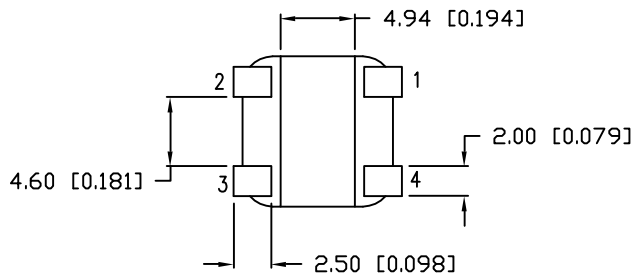

LEAD FREE REFLOW PROFILE

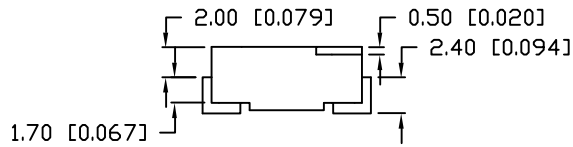
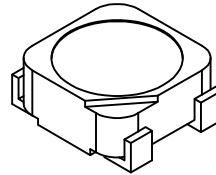
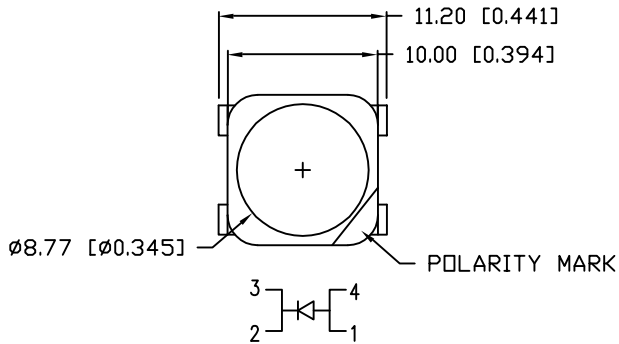
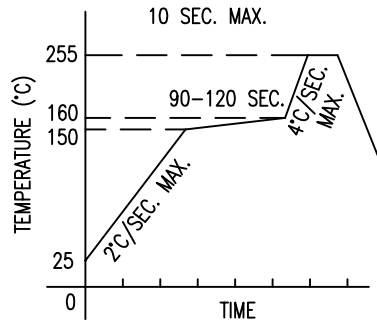

TOTAL TIME ABOVE 220°C IS 60 SECONDS MAX.

ELECTRO-OPTICAL CHARACTERISTICS  $T_A=25^\circ\text{C}$   $I_f=350\text{mA}$

| PARAMETER          | MIN         | TYP   | MAX | UNITS    | TEST COND            |
|--------------------|-------------|-------|-----|----------|----------------------|
| PEAK WAVELENGTH    |             | 525   |     | nm       |                      |
| FORWARD VOLTAGE    |             | 3.5   | 4.0 | $V_f$    |                      |
| REVERSE VOLTAGE    | 5.0         |       |     | $V_r$    | $I_r=100\mu\text{A}$ |
| AXIAL INTENSITY    |             | 10000 |     | mcd      | $I_f=350\text{mA}$   |
| LUMINOUS FLUX      |             | 20    |     | lm       | $I_f=350\text{mA}$   |
| VIEWING ANGLE      |             | 90    |     | 2x theta |                      |
| EMITTED COLOR:     | GREEN       |       |     |          |                      |
| EPOXY LENS FINISH: | WATER CLEAR |       |     |          |                      |

LIMITS OF SAFE OPERATION AT 25°C

| PARAMETER             | MAX        | UNITS |
|-----------------------|------------|-------|
| PEAK FORWARD CURRENT* | 500        | mA    |
| STEADY CURRENT        | 350        | mA    |
| POWER DISSIPATION     | 1.2        | W     |
| DERATE FROM 25°C      | -1.2       | mW/°C |
| OPERATING TEMP.       | -40 TO +85 | °C    |
| STORAGE TEMP.         | -40 TO +85 | °C    |

CAUTION: STATIC SENSITIVE DEVICE  
FOLLOW PROPER E.S.D. HANDLING PROCEDURES  
WHEN WORKING WITH THIS PART.

RECOMMENDED SOLDER PAD LAYOUT

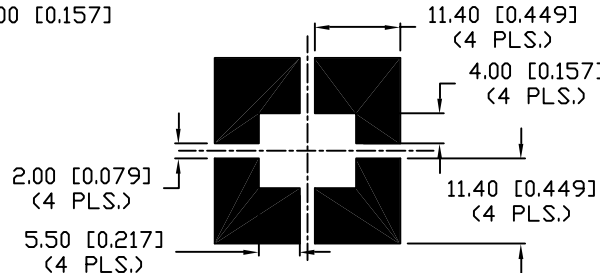
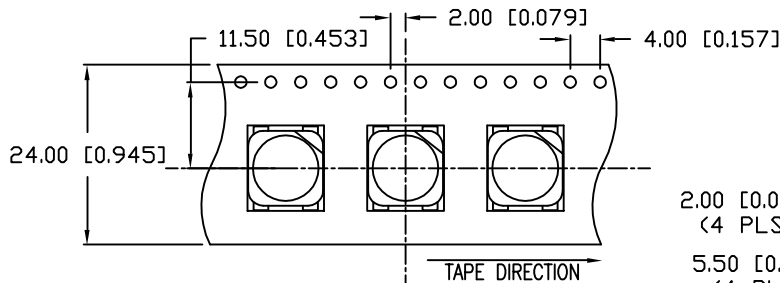

NOTES:

1. ANODE TOWARDS TAPE HOLE.



\*UNLESS OTHERWISE SPECIFIED TOLERANCES PER DECIMAL PRECISION ARE: X=±1 (±0.039), X.X=±0.5 (±0.020), X.XX=±0.25 (±0.010), X.XXX=±0.127 (±0.005). LEAD SIZE=±0.05 (±0.002), LEAD LENGTH=±0.75 (±0.030). MIN.= +DECIMAL PRECISION -0.00 MAX.= +0.00 -DECIMAL PRECISION

| REV. | PART NUMBER        |
|------|--------------------|
| A    | SML-LX1110UPGC-ATR |

**CONFIDENTIAL INFORMATION**  
THE INFORMATION CONTAINED IN THIS DOCUMENT IS THE PROPERTY OF LUMEX INC. EXCEPT AS SPECIFICALLY AUTHORIZED IN WRITING BY LUMEX INC., THE HOLDER OF THIS DOCUMENT SHALL KEEP ALL INFORMATION CONTAINED HEREIN CONFIDENTIAL AND SHALL PROTECT SAME IN WHOLE OR IN PART FROM DISCLOSURE AND DISSEMINATION TO ALL THIRD PARTIES.



290 E. HELEN ROAD  
PALATINE, IL 60067-6976  
PHONE: +1.847.359.2790  
US WEB: www.lumex.com  
TW WEB: www.lumex.com.tw

PLCC-4 SMT LED, HIGH POWER, 525nm ULTRA PURE GREEN,  
WITH INTERNAL REFLECTIVE CAVITY.

**RELIABILITY NOTE**  
OUR MANY YEARS OF EXPERIENCE DATA ACCUMULATION INDICATE THAT SOLDER HEAT IS A MAJOR CAUSE OF EARLY AND FUTURE FAILURE. PLEASE PAY ATTENTION TO YOUR SOLDERING PROCESS.

|                 |             |              |               |
|-----------------|-------------|--------------|---------------|
| DRAWN BY:<br>JD | CHECKED BY: | APPROVED BY: | DATE: 7.11.05 |
|                 |             |              | PAGE: 1 OF 1  |
|                 |             |              | SCALE: N/A    |