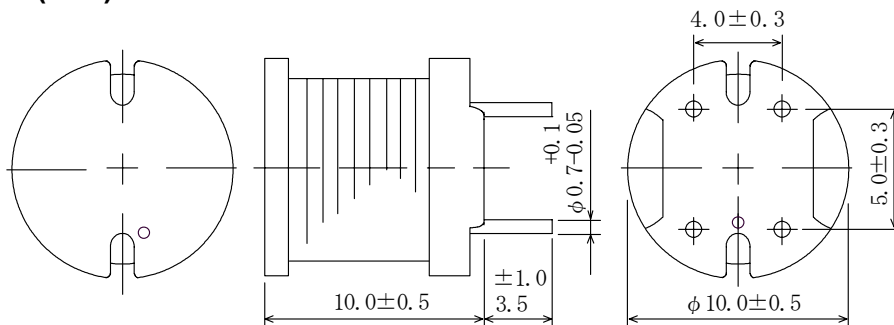
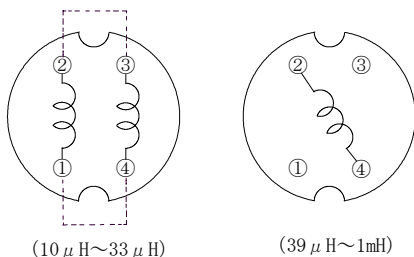

Type: RCH-110
◆ Product Description

- 10.5mm Max. ϕ , 10.5mm Max. Height.
- Inductance range: $10 \mu\text{H} \sim 1.0\text{mH}$
- Rated current range: $0.53 \sim 5.3\text{A}$
- In addition to the standard versions of inductors shown here, custom inductors are available to meet your exact requirements.

◆ Feature

- Magnetically unshielded construction.
- Ideally Used in Printers, LCD TV, DVD, Printer, Copy Machine, Mainboard of the compounding machines, etc as Power Supplies's Inductors or DC-DC Converter inductors.
- RoHS Compliance

◆ Dimensions (mm)

◆ Schematics (Bottom)

- * To be connected between #1 and #4, #2 and #3 when used. ($10 \mu\text{H} \sim 33 \mu\text{H}$).
- * It is no matter for the electric characteristics if terminal 1 is connected to terminal 4, terminal 2 is connected to terminal 3 with solder. (On the bottom of drum core) ($10 \mu\text{H} \sim 33 \mu\text{H}$)

Type: RCH-110
◆ Specification

Part Name	Stamp	Inductance (at 1kHz) [Within]	D.C.R.(Ω) [Max.] (at20°C)	Rated Current (A)※1	S.R.F. (MHz) Typ.	Mounting holes (mm) ※2
RCH110NP-100M	100M	10 μH ± 20%	0.022	5.3	14	1.4
RCH110NP-120M	120M	12 μH ± 20%	0.023	4.9	11	1.4
RCH110NP-150M	150M	15 μH ± 20%	0.026	4.4	7.7	1.4
RCH110NP-180M	180M	18 μH ± 20%	0.033	4.0	7.1	1.2
RCH110NP-220M	220M	22 μH ± 20%	0.037	3.6	6.8	1.2
RCH110NP-270M	270M	27 μH ± 20%	0.048	3.3	6.1	1.2
RCH110NP-330K	330K	33 μH ± 10%	0.055	2.9	6.0	1.2
RCH110NP-390K	390K	39 μH ± 10%	0.073	2.7	8.6	1.2
RCH110NP-470K	470K	47 μH ± 10%	0.083	2.5	8.1	1.2
RCH110NP-560K	560K	56 μH ± 10%	0.092	2.3	7.6	1.2
RCH110NP-680K	680K	68 μH ± 10%	0.12	2.1	6.3	1.2
RCH110NP-820K	820K	82 μH ± 10%	0.14	1.9	6.0	1.2
RCH110NP-101K	101K	100 μH ± 10%	0.16	1.7	5.7	1.2
RCH110NP-121K	121K	120 μH ± 10%	0.20	1.5	4.8	1.2
RCH110NP-151K	151K	150 μH ± 10%	0.23	1.4	4.2	1.2
RCH110NP-181K	181K	180 μH ± 10%	0.31	1.3	3.9	1.2
RCH110NP-221K	221K	220 μH ± 10%	0.34	1.1	3.8	1.2
RCH110NP-271K	271K	270 μH ± 10%	0.40	1.0	3.4	1.2
RCH110NP-331K	331K	330 μH ± 10%	0.52	0.93	2.8	1.0
RCH110NP-391K	391K	390 μH ± 10%	0.65	0.86	2.7	1.0
RCH110NP-471K	471K	470 μH ± 10%	0.71	0.78	2.5	1.0
RCH110NP-561K	561K	560 μH ± 10%	1.0	0.71	2.2	1.0
RCH110NP-681K	681K	680 μH ± 10%	1.1	0.65	2.1	1.0
RCH110NP-821K	821K	820 μH ± 10%	1.3	0.59	2.0	1.0
RCH110NP-102K	102K	1.0 mH ± 10%	1.7	0.53	1.7	1.0

※1: Rated current: The DC current at which the inductance decreases 90% of it's initial value
or when $\Delta t=40^{\circ}\text{C}$ whichever is lower($T_a=20^{\circ}\text{C}$)

※2: Please give sufficient consideration to the thickness of wire while mounted into P.C.B.