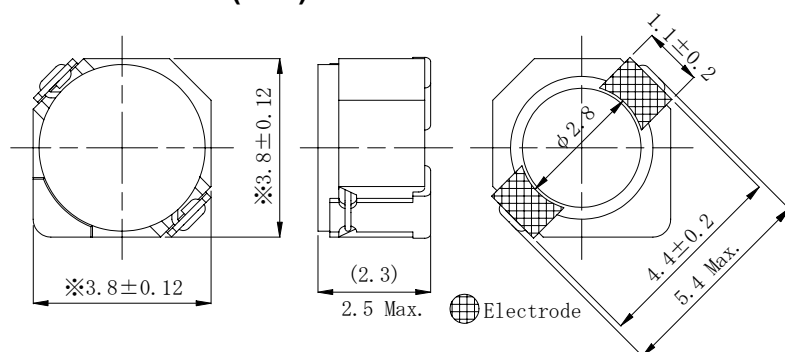
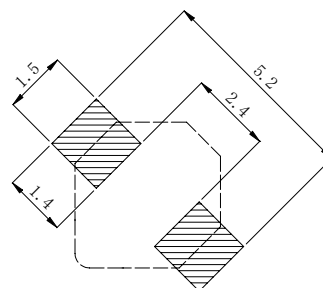

Type: CDRH3D23; CDH3D23/HP
◆ Product Description

- 3.92×3.92mm Max.(L×W), 2.5mm Max. Height.
- Inductance range: 1.0~47.0 μ H
- Rated current range: 0.35~2.8A(CDRH3D23);0.53~2.55A(CDRH3D23/HP)
- Custom design is available.

◆ Feature

- Magnetically shielded construction.
- Ideally used in Mobilephone,PDA,MP3,DSC/DVC etc as DC-DC Converter inductors.
- RoHS Compliance.

◆ Dimensions (mm)

◆ Land Pattern (mm)

◆ Specification (CDRH3D23)

| Part Name ※ | Stamp | Inductance (μ H) 100kHz/1V | D.C.R.(mΩ) Max.(Typ.) (at 20℃) | Saturation Current (A) ※1 | | Temperature Rise Current (A)※2 |
|------------------|-------|-----------------------------------|--------------------------------------|------------------------------|-----------|--------------------------------------|
| | | | | (at 20℃) | (at 100℃) | |
| CDRH3D23NP-1R0P□ | A | 1.0μH±25% | 25.0(20) | 2.80 | 2.00 | 3.10 |
| CDRH3D23NP-1R5P□ | B | 1.5μH±25% | 29.0(24) | 2.20 | 1.65 | 2.90 |
| CDRH3D23NP-2R2P□ | C | 2.2μH±25% | 38.3(31) | 1.80 | 1.30 | 2.50 |
| CDRH3D23NP-3R3P□ | D | 3.3μH±25% | 56.3(45) | 1.45 | 1.10 | 2.20 |
| CDRH3D23NP-4R7P□ | E | 4.7μH±25% | 68.8(55) | 1.30 | 0.95 | 1.90 |
| CDRH3D23NP-5R6P□ | F | 5.6μH±25% | 75.0(60) | 1.10 | 0.80 | 1.80 |
| CDRH3D23NP-6R8P□ | G | 6.8μH±25% | 87.8(72) | 1.00 | 0.75 | 1.70 |
| CDRH3D23NP-8R2P□ | H | 8.2μH±25% | 94.8(77) | 0.95 | 0.70 | 1.60 |
| CDRH3D23NP-100M□ | I | 10.0μH±20% | 117(95) | 0.85 | 0.60 | 1.40 |
| CDRH3D23NP-150M□ | J | 15.0μH±20% | 191(154) | 0.70 | 0.50 | 0.85 |
| CDRH3D23NP-220M□ | K | 22.0μH±20% | 270(219) | 0.55 | 0.40 | 0.75 |
| CDRH3D23NP-330M□ | L | 33.0μH±20% | 381(307) | 0.50 | 0.35 | 0.6 |
| CDRH3D23NP-470M□ | M | 47.0μH±20% | 546(441) | 0.35 | 0.25 | 0.55 |

Type: CDRH3D23; CDH3D23/HP
◆ Specification (CDRH3D23/HP)

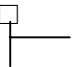
| Part Name ※ | Stamp | Inductance (μ H) 100kHz/1V | D.C.R.(m Ω) Max.(Typ.) (at 20°C) | Saturation Current (A) ※1 | | Temperature Rise Current (A)※2 |
|--------------------|-------|---------------------------------------|--|------------------------------|------------|--------------------------------------|
| | | | | (at 20°C) | (at 100°C) | |
| CDRH3D23HPNP-1R2P□ | B | 1.2±25% | 40.4(32.3) | 3.52 | 3.00 | 2.55 |
| CDRH3D23HPNP-2R2P□ | E | 2.2±25% | 50.3(40.2) | 2.6 | 2.24 | 2.25 |
| CDRH3D23HPNP-2R7P□ | F | 2.7±25% | 62.3(49.8) | 2.4 | 2.08 | 2.0 |
| CDRH3D23HPNP-3R3P□ | G | 3.3±25% | 70.0(56.0) | 2.2 | 1.9 | 1.85 |
| CDRH3D23HPNP-4R7P□ | J | 4.7±25% | 95.5(76.4) | 1.84 | 1.57 | 1.60 |
| CDRH3D23HPNP-5R6P□ | K | 5.6±25% | 102(81.2) | 1.66 | 1.44 | 1.50 |
| CDRH3D23HPNP-6R8P□ | L | 6.8±25% | 136(109) | 1.52 | 1.3 | 1.30 |
| CDRH3D23HPNP-8R2P□ | N | 8.2±25% | 145(116) | 1.36 | 1.18 | 1.25 |
| CDRH3D23HPNP-100M□ | A | 10±20% | 198(158) | 1.28 | 1.08 | 1.02 |
| CDRH3D23HPNP-120M□ | B | 12±20% | 249(199) | 1.14 | 0.97 | 0.95 |
| CDRH3D23HPNP-150M□ | C | 15±20% | 276(221) | 1.02 | 0.88 | 0.90 |
| CDRH3D23HPNP-220M□ | E | 22±20% | 383(306) | 0.8 | 0.65 | 0.70 |
| CDRH3D23HPNP-330M□ | G | 33±20% | 555(444) | 0.68 | 0.58 | 0.58 |
| CDRH3D23HPNP-470M□ | J | 47±20% | 669(535) | 0.56 | 0.48 | 0.53 |

※ Description Of Part Name

CDRH3D23NP-1R0P□

 B: Box
 C: Carrier Tape

※1.Saturation current: The DC current at which the inductance decreases to 65% of its nominal value.

※2.Temperature rise current: The DC current at which the temperature rise is $\Delta t=40^{\circ}\text{C}$.($T_a=20^{\circ}\text{C}$)