

ISOLATED SURFACE MOUNT POWER SCHOTTKY CENTER-TAP RECTIFIER



Hermetic Surface Mount Package 10 Amp, 45 Volt Schottky Center-Tap

FEATURES

- Hermetic Surface Mount Package
- Very Low Forward Voltage
- Low Recovery Charge
- High Efficiency For Low Voltage Supplies
- 45V Blocking @ Rated T_{jmax}
- 50V Repetitive Surge Voltage
- Center-Tap Configuration
- Available Hi-Rel Screened

DESCRIPTION

This series of surface mount devices offer two Schottky barriers arranged in a common cathode configuration and is ideally suited for a full wave output rectifier in low voltage switching power supplies where small size and high reliability are required. Common anode configuration also available.

ABSOLUTE MAXIMUM RATINGS ($T_c=25^\circ\text{C}$) Per Diode

Peak Inverse Voltage.....	45 V
Maximum Average D.C. Output Current.....	5 A
Peak Surge Current (Non-Repetitive, 8.3ms)	60 A
Peak Reverse Transient Current	1.0 A
Storage Temperature Range	- 55° C to + 175° C
Junction Operating Temperature Range	- 55° C to + 150° C
Package Thermal Resistance, Junction-to-Case	2.5° C/W

SCHEMATIC

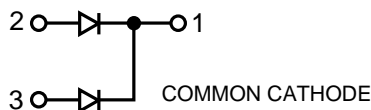

Contact factory for common anode,
common cathode is standard.

PIN CONNECTION

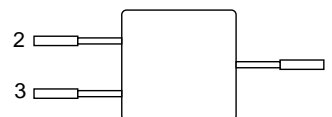

Pin 1: DC
Pin 2: AC
Pin 3: AC
Case: Isolated

3.5

ELECTRICAL CHARACTERISTICS (Per Diode)

Symbol	Characteristic	Conditions	Max.	Units
V_F	Maximum Instantaneous Forward Voltage ¹	$I_F = 5A, T_C = 125^\circ C$.600	V
		$I_F = 5A, T_C = 25^\circ C$.750	V
i_R	Maximum Instantaneous Reverse Current ¹	Rated dc Voltage, $T_C = 125^\circ C$	18	mA
		Rated dc Voltage, $T_C = 25^\circ C$	1.0	mA

(1) Pulse Test: Pulse width = 300 μ s, Duty Cycle 2.0%.

TYPICAL FORWARD VOLTAGE

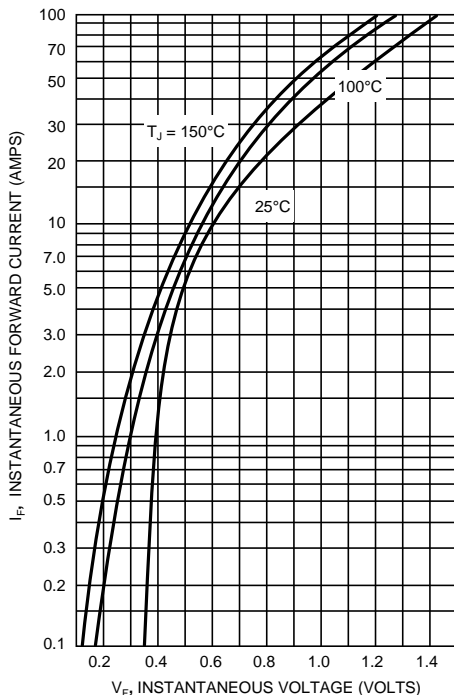

MAXIMUM REVERSE CURRENT

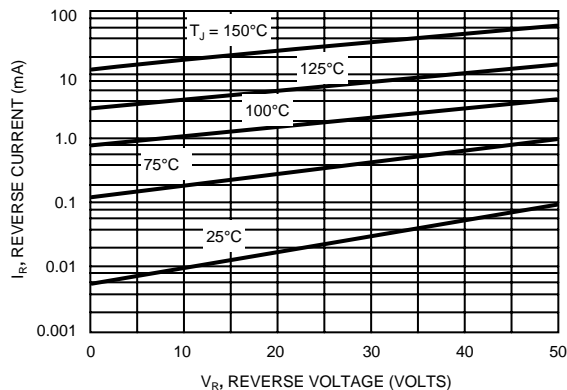

MECHANICAL OUTLINE

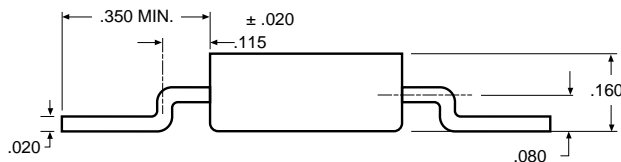
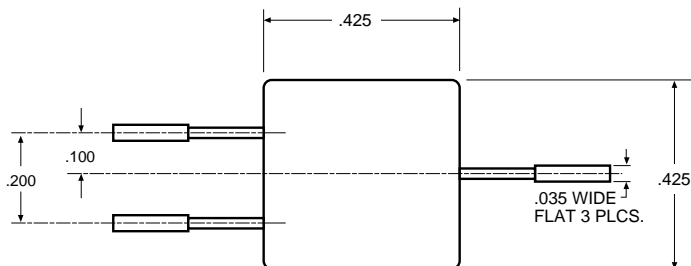

3.5