



# EVERLIGHT ELECTRONICS CO.,LTD.

Device Number : CDDS-512-012 REV: 1

0.56" Single Digit Displays

PART NO. : ELS-512GDB ECN :                      Page: 1/5

■ Features :

- Industrial standard size.
- Low power consumption.
- Categorized for luminous intensity.

■ Applications:

- Audio equipment
- Instrument panels
- Digital read out display

■ Descriptions :

- The ELS-512 series is a large 14.22mm (0.56")high seven segment display designed for viewing distances up to 7 meters.
- These displays provide excellent reliability in bright ambient light.
- These devices are made with green segments and black surface.

PART NO.	Chip	
	Material	Emitted Color
ELS-512GDB	GaP	Green

OFFICE : 7c Building ,Lian Hua Port Industrial District, Lian Hua Shan Bonded Pricessing Zone Pan Yu, Guang Zhou, China

TEL : (020) 84860913 , 84860914

FAX : (020) 84860600

<http://www.everlight.com>

0.56" Single Digit Displays

PART NO. : ELS-512GDBECN : Page: 2/5

## ■ Package Dimensions:

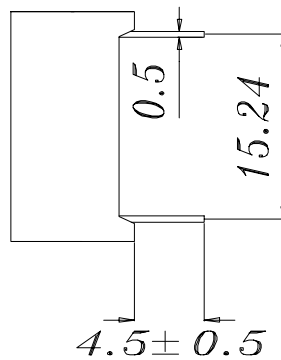
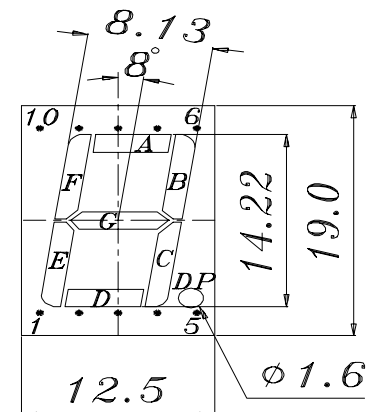

COMMON ANODE  
 1 CATHODE E  
 2 CATHODE D  
 3 COMMON ANODE  
 4 CATHODE C  
 5 CATHODE DP  
 6 CATHODE B  
 7 CATHODE A  
 8 COMMON ANODE  
 9 CATHODE F  
 10 CATHODE G

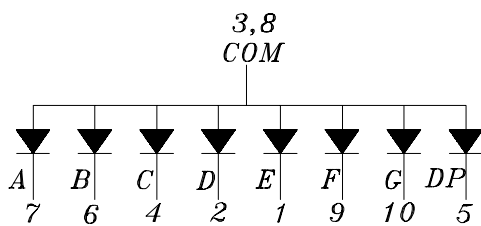
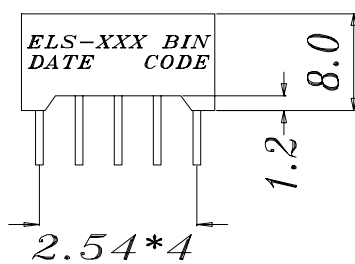

## ■ Notes:

- 1.All dimensions are in millimeters , tolerance is 0.25mm unless otherwise noted.
- 2.Above specification may be changed without notice.

Supplier will reserve authority on material change for above specification.



Device Number :       CDDS-512-012       REV:       1      

0.56" Single Digit Displays

PART NO. :       ELS-512GDB       ECN :                      Page:       3/5      

■ Absolute maximum ratings at Ta = 25°C :

Parameter	Symbol	Rating	Unit
Reverse Voltage	VR	5	V
Forward Current	IF	30	mA
Operating Temperature	Topr	-40 to +85	°C
Storage Temperature	Tstg	-40 to +100	°C
Soldering Temperature	Tsol	260 ± 5	°C
Power Dissipation	Pd	100	mW
Peak Forward Current(Duty 1/10 @ 1KHz)	IF(Peak)	160	mA

■ Electronic optical characteristics :

Parameter		Symbol	Min.	Typ.	Max.	Unit	Condition
Luminous Intensity	Per segment	Iv	0.75	1.68	----	mcd	IF=10mA
	Per decimal point		0.30	0.50	----		
Peak Wavelength		$\lambda_p$	----	565	----	nm	IF=20mA
Dominant Wavelength		$\lambda_d$	----	570	----	nm	IF=20mA
Spectrum Radiation	Bandwidth	$\Delta \lambda$	----	30	----	nm	IF=20mA
Forward Voltage		VF	1.7	2.1	2.4	V	IF=20mA
Reverse Current		IR	----	----	10	$\mu A$	VR=5V



0.56" Single Digit Displays

PART NO. : ELS-512GDB

ECN :                     

Page: 4/5

■ Typical Electro-Optical Characteristic Curves:

GHIP Material:Gap  
Emitted Color:Yellow Green

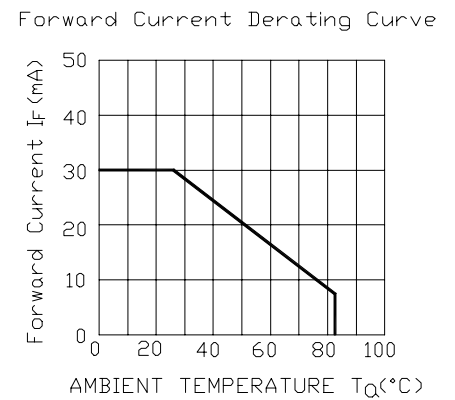
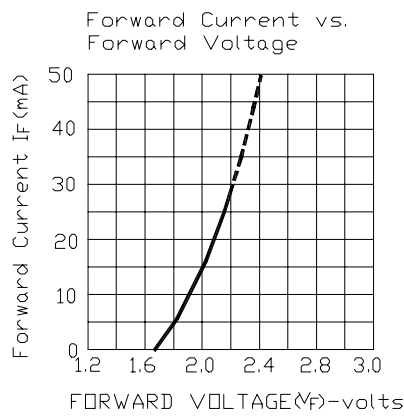
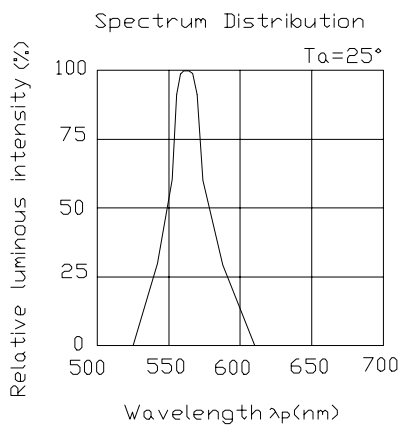



# EVERLIGHT ELECTRONICS CO.,LTD.

Device Number : CDDS-512-012 REV: 1

0.56" Single Digit Displays

PART NO. : ELS-512GDB ECN :                      Page: 5/5

■ Reliability test items and conditions:

NO	Item	Test Conditions	Test Hours/Cycle	Sample Size	Ac/Re
1	Solder Heat	TEMP : 260°C ± 5 °C	5 SEC	76 PCS	0/1
2	Temperature Cycle	H : +85°C 30min ∩ 5 min L : -55°C 30min	50 CYCLE	76 PCS	0/1
3	Thermal Shock	H : +100°C 5min ∩ 10 sec L : -10°C 5min	50 CYCLE	76 PCS	0/1
4	High Temperature Storage	TEMP : 100°C	1000 HRS	76 PCS	0/1
5	Low Temperature Storage	TEMP : -55°C	1000 HRS	76 PCS	0/1
6	DC Operating Life	IF = 10 mA	1000 HRS	76 PCS	0/1
7	High Temperature / High Humidity	85°C /85% RH	1000 HRS	76 PCS	0/1

--	--	--	--	--	--