

Inverse DIN 41612 Boardmount Socket

2 Row Type Q (Rows A & B Filled)

7164 Series

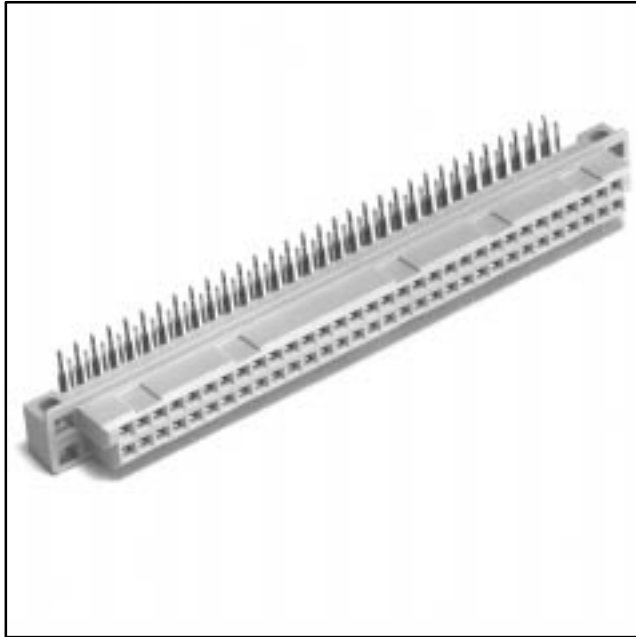

- High density (64 position)
- Low mating force minimizes plating wear on contact surfaces
- High reliability contact design
- Individual connector coding with the 3435-1 keying plug

Date Modified: February 19, 1999

TS-0429-07
Sheet 1 of 2

93

Physical

Insulation

Material: Glass Filled Polyester (PBT)
Flammability: UL 94V-0
Color: Gray

Contact

Material: Phosphor Bronze
Plating
Underplate: 79 μ " (2.00 μ m) Nickel — QQ-N-290, Class 2
Wiping Area: 15 μ " (0.38 μ m) Gold — MIL-G-45204, Type II, Grade C
Solder Tails: 200 μ " (5.08 μ m) 60/40 Tin Lead — MIL-P-81728

Electrical

Current Rating: 3 A
Insulation Resistance: $> 1 \times 10^{12} \Omega$ at 1000 Vdc
Withstanding Voltage: 1000 Vrms at Sea Level
Contact Resistance: < 15 Milliohms

Environmental

Temperature Rating: -55°C to $+125^{\circ}\text{C}$

UL File No.: E68080

3M Interconnect Solutions Division

6801 River Place Blvd.
Austin, TX 78726-9000

For technical, sales or ordering information call
800-225-5373

Inverse DIN 41612 Boardmount Socket

2 Row Type Q (Rows A & B Filled)

7164 Series

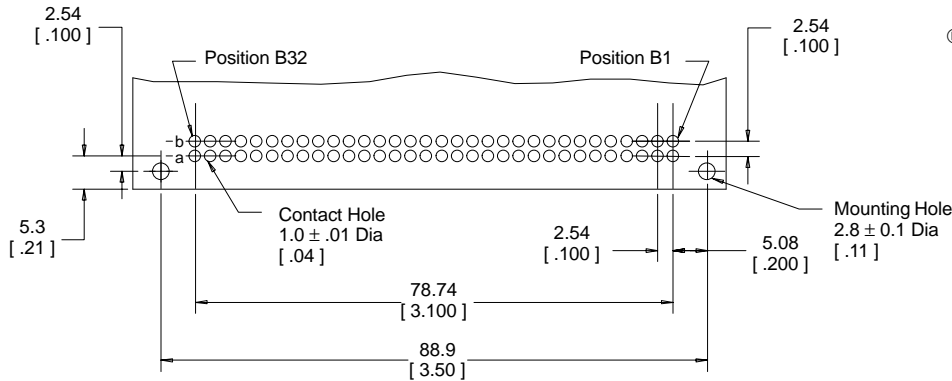
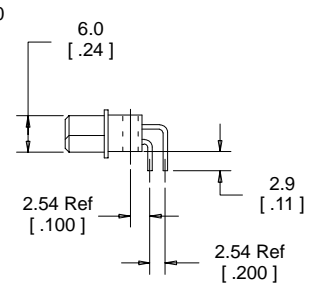
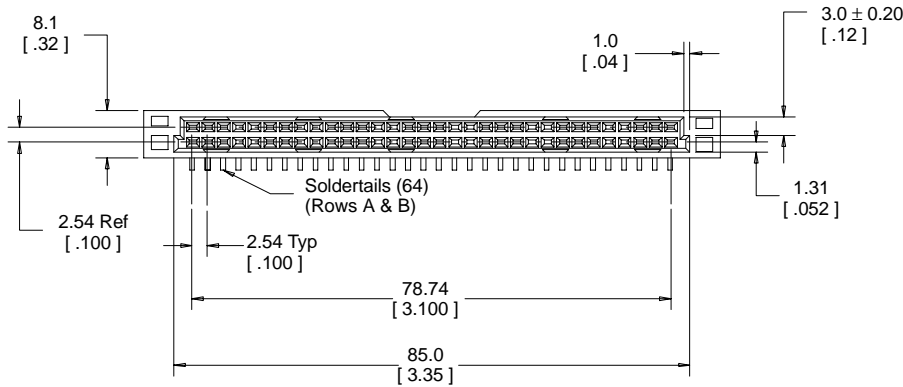
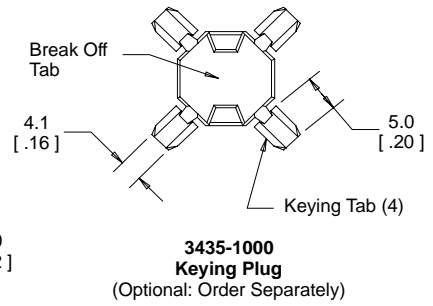
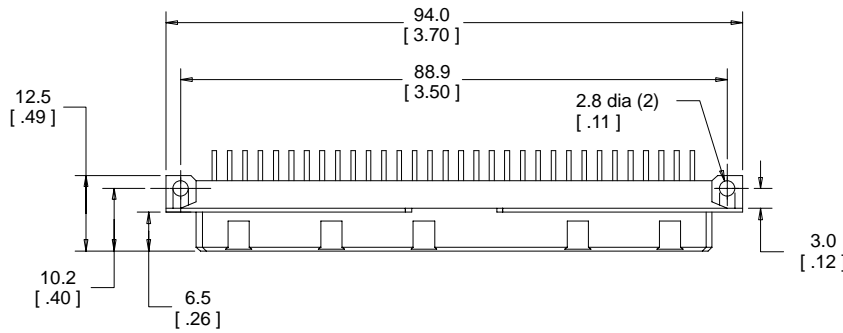

Recommended Hole Pattern
(Shown for Mounting Side of Board)

mm [Inch]			
Tolerance Unless Noted			
	.0	.00	.000
mm	±.3	±.13	///

[] Dimensions for Reference only

Ordering Information

Inverse Din 41612
Right Angle Boardmount Socket
7164-50B2TH

Keying Plug
(Order Separately)
3435-1000

TS-0429-07
Sheet 2 of 2

3M Interconnect Solutions Division

6801 River Place Blvd.
Austin, TX 78726-9000

For technical, sales or ordering information call
800-225-5373