

# Spice Model

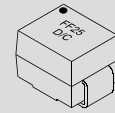

**MD90FF25**



Part Number	Working Reverse Voltage (Vrwm)	Average Rectified Current (Io)		Reverse Current @ Vrwm (Ir)		Forward Voltage (Vf)		1 Cycle Surge Current tp=8.3ms (Ifsm)	Repetitive Surge Current (Ifrm)	Reverse Recovery Time (3) (Trr)	Thermal Impd. J-L °C/W	Junction Cap. @50VDC @1kHz (Cj) pF	Markings
		55°C(1)	100°C(2)	25°C	100°C	25°C	25°C						
	Volts	Amps	Amps	µA	µA	Volts	Amps	Amps	Amps	ns			
MD90FF25	2500	0.35	0.20	1.0	25	6.2	0.50	10	2.5	30	26	10	FF25

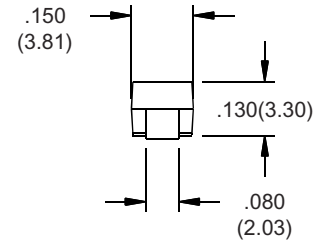
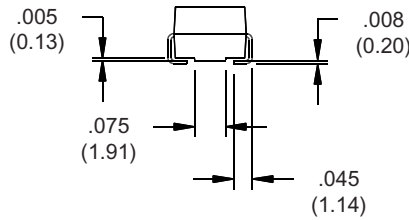
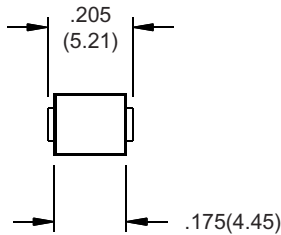

NAME	PARAMETER	VALUE	UNITS
IS	Reverse leakage current	1.00E-06	Amps
N	Emission coefficient	16.5	
T	Temperature	25	C
RS	Diode series resistance	1.9	Ohm
TT	Transit time	30	nS
CJ0	Zero-bias junction capacitance	18.23	pF
VJ	Bulk junction potential	1.41	Volts
M	Grading coefficient	0.5	
EG	Energy-band gap	1.11	Volts
XTI	Temperature coefficient	3	
KF	Flicker-noise coefficient	0	
AF	Flicker-noise exponent	1	
FC	Coefficient for capacitance	0.5	
BV	Diode breakdown voltage	2500	Volts
IBV	Diode breakdown current	100	uAmps



**Voltage Multipliers, Inc.**  
8711 W. Roosevelt Ave.  
Visalia, CA 93291

Tel (559) 651-1402  
Fax (559) 651-0740  
www.voltagemultipliers.com