

REVISIONS			
LTR	DESCRIPTION	DATE	APPROVED
A	NEW DRAWING		

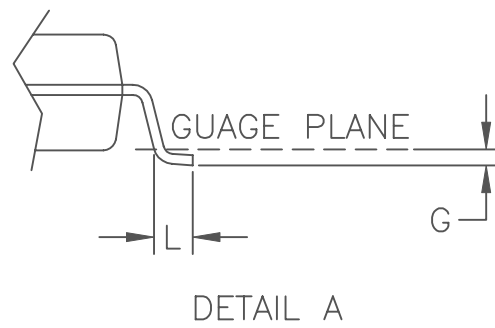
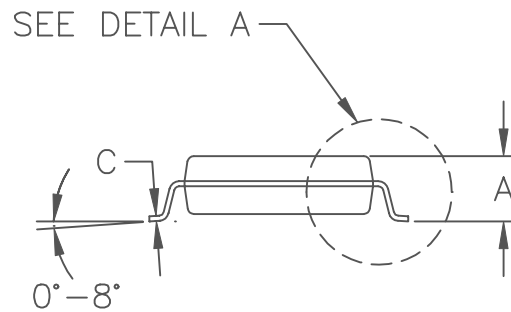
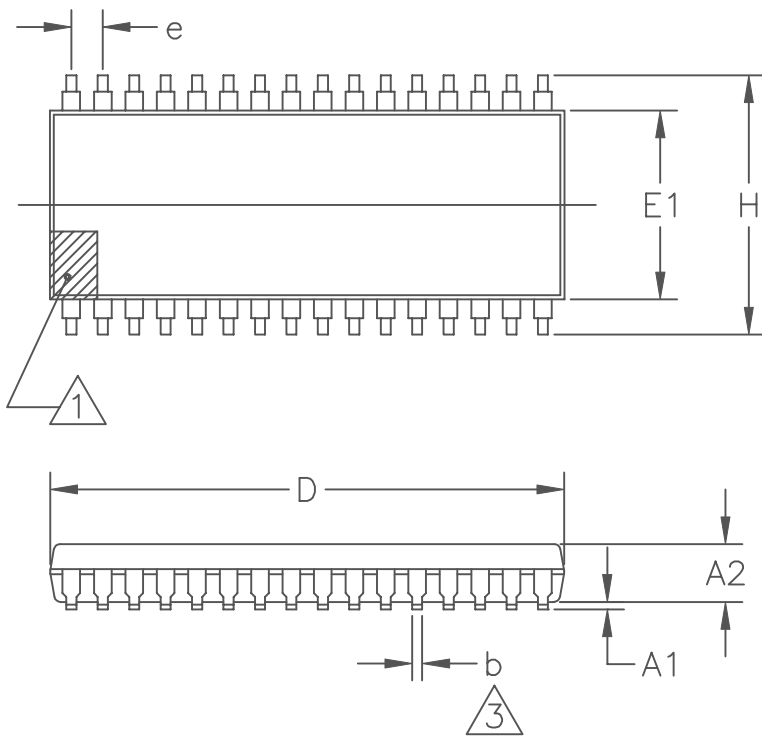

LTR	MIN	MAX
A	IN. —	.104
	MM —	2.64
A1	IN. .004	—
	MM .102	—
A2	IN. .082	.094
	MM 2.08	2.39
b	IN. .014	.020
	MM 0.36	0.51
C	IN. .006	.013
	MM 0.15	0.33
D	IN. .810	.824
	MM 20.57	20.93
e	IN. .050 BSC	
	MM 1.27 BSC	
E1	IN. .292	.299
	MM 7.42	7.59
H	IN. .405	.419
	MM 10.29	10.64
L	IN. .021	.041
	MM 0.53	1.04
G	IN. .014 BSC	
	MM 0.36 BSC	

NOTES:

- 1 A TERMINAL 1 IDENTIFIER MUST BE POSITIONED SO THAT 1/2 OR MORE OF IT'S AREA IS CONTAINED IN THE HATCHED ZONE.
- 2 "D" AND "E1" DIMENSIONS DO NOT INCLUDE MOLD FLASH OR PROTRUSIONS, BUT DOES INCLUDE MOLD MISMATCH AND ARE MEASURED AT THE MOLD PARTING LINE. MOLD FLASH OR PROTRUSIONS SHALL NOT EXCEED .003 INCHES PER SIDE.
- 3 DIMENSION "b" IS MEASURED BELOW THE LOWER RADIUS OF THE FOOT.

SIGNATURE		DATE				
DOC. CONTROL:						
ENGR. MGR: M. STRITTMATTER		1/98	TITLE MARKETING OUTLINE— .300" SOIC 32 LEAD .050" PITCH			
MFG. ENGR: B. MCCARTY		9/97				
CHECKED BY: R. RADKE		9/97	SIZE	FSCM NO	PART NO.	REV
DRAWN BY: R.W.E.		9/97	A		56-G4009-032	A
DO NOT SCALE DWG.		SCALE N/A	SHEET 1 OF 1			