



SMD0705

CRYSTAL UNIT

1. SCOPE

This specification shall cover the characteristics of crystal unit with
SMD0705-10.00—27.00MHz

2. ELECTRICAL SPECIFICATION

ITEM	SPECIFICATION
HOLDER TYPE	SMD0705
NOMINAL FREQUENCY	10.00—27.00MHz
LOAD CAPACITANCE	10PF to series
OSCILLATION MODE	Fundamental
FREQUENCY TOLERANCE AT 25°C ±2°C	± 30PPM
EQUIVALENT SERIES RESISTANCE	40 Ω max.
DRIVE LEVEL	0.5MW
OPERATING TEMPERATURE RANGE	-10°C ~+60°C
FREQUENCY STABILITY	± 30PPM
SHUNT CAPACITANCE	<7PF
AGING	± 5PPM/YEAR
INSULATION RESISTANCE	>500M Ω at DC 100V

3.Dimension (mm)

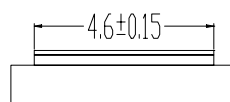
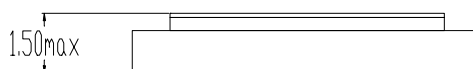
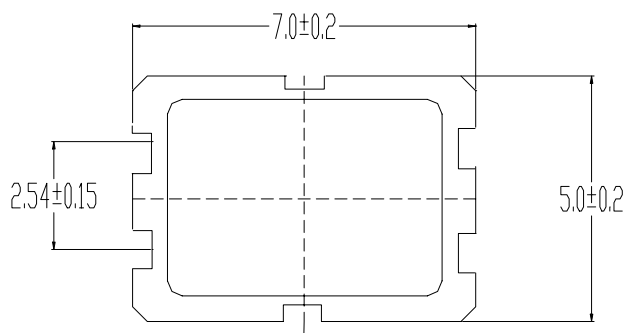

4. MECHANICAL SPECIFICATION

1) Terminal Strength

* Lead pulling test

Conditions: Load 907.2 gram
Direction To the downward
Duration of applied force 5 seconds
Results: There should be no distortion in appearance.

* Lead bending test

Conditions: Load 453.6 gram
Bending angle 90° to normal position
Rate of bending 3 seconds in each cycle
Number of bending 3
Results: There should be no distortion in appearance.

2) Lead solderability test

Conditions: Dipping in solder($+230^\circ\text{C} \pm 5^\circ\text{C}$) for 5 seconds
Results: More than 95% of surface being tested should be coated uniformly with solder.

3) Vibration test

Conditions: Frequency 10 – 55Hz
Amplitude 0.762mm
Sweep 1.0 minute
Duration 2 hours
Results: Frequency and wave form of tested products must remain within specifications.

4) Drop test

Conditions: Method of drop Natural drop
Dropping floor Hard wood board
Height 30cm
Number of drops 3 times
Results: Frequency and wave form of tested products must remain within specifications.

Results:

- a. Insulation resistance must be 500 M Ω /100 Vac. minimum
- b. Resistance and wave form must remain within specifications.